



FOR LEASE
**Antelope Business Park
Syracuse Phase I & II**
1100 West 350 South / Syracuse, Utah



FOR LEASE
**Antelope Business Park
Syracuse Phase I & II**
1100 West 350 South / Syracuse, Utah

Aerial



Property Highlights

- 220,002 Total SF
 - Phase I:**
 - Building 1: 32,206 SF
 - Building 2: 48,600 SF
 - Phase II:**
 - Building 3: 39,000 SF
 - Building 4: 104,140 SF
- 12' x 14' grade level doors
- 9' x 10' dock high doors
- ESFR fire suppression
- Fiber optics to buildings
- Divisible bay sizes from 5,400 - 45,000 SF
- Fronts Highway 193, less than 2 miles from I-15
- Lease Rates:
 - \$0.65 PSF, NNN Warehouse
 - \$1.10 PSF, NNN Office



Jeremy Terry Industrial Specialist +1 801 303 5561 jeremy.terry@cushwake.com	Tom Freeman, SIOR Executive Director +1 801 303 5449 tom.freeman@cushwake.com	Travis Healey, SIOR Senior Director +1 801 303 5565 travis.healey@cushwake.com	Josh Wangsgard Industrial/Investment Specialist +1 801 525 3000 josh.wangsgard@cushwake.com	170 South Main Street Suite 1600 Salt Lake City, UT 84101 Main +1 801 322 2000 Fax +1 801 322 2040 cushmanwakefield.com
--	---	--	---	--

Jeremy Terry Industrial Specialist +1 801 303 5561 jeremy.terry@cushwake.com	Tom Freeman, SIOR Executive Director +1 801 303 5449 tom.freeman@cushwake.com	Travis Healey, SIOR Senior Director +1 801 303 5565 travis.healey@cushwake.com	Josh Wangsgard Industrial/Investment Specialist +1 801 525 3000 josh.wangsgard@cushwake.com	170 South Main Street Suite 1600 Salt Lake City, UT 84101 Main +1 801 322 2000 Fax +1 801 322 2040 cushmanwakefield.com
--	---	--	---	--

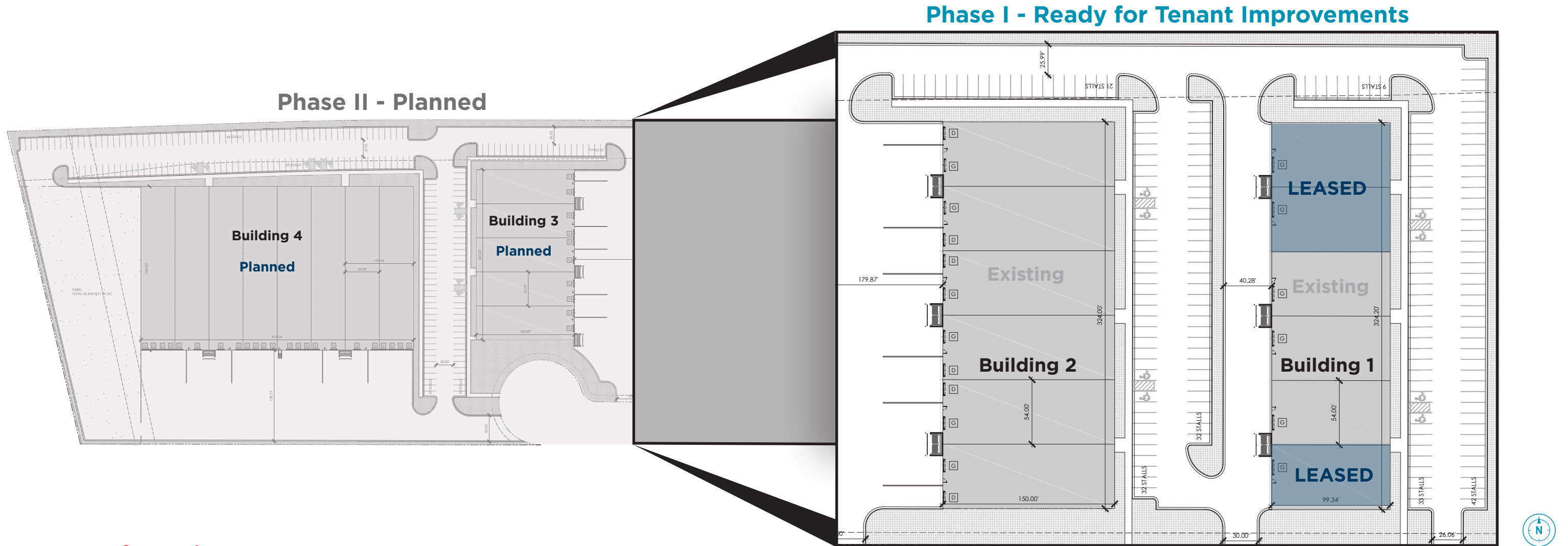

Property Information

Building 4

- Total size: 104,140 SF
- Available: 104,140 SF
- Divisible to: 26,000 SF units
- Office: Finish to suit
- Clear height: 32'
- Car parking: 158 stalls allocated to building
- Power: 600A, 208/480V, 3 phase
- Loading: (19) DH doors
(4) GL doors

Building 3

- Total size: 39,000 SF
- Available: 39,000 SF
- Divisible to: 7,800 SF units
- Office: Finish to suit
- Clear height: 28'
- Car parking: 55 stalls allocated to building
- Power: 600A, 208/480V, 3 phase
- Loading: (5) DH doors
(5) GL doors

Building 2

- Total size: 48,600 SF
- Available: 48,600 SF
- Divisible to: 8,100 SF units
- Office: Finish to suit
- Clear height: 28'
- Car parking: 85 stalls allocated to building
- Power: 600A, 208/480V, 3 phase
- Loading: (6) DH doors
(6) GL doors

Building 1

- Total size: 32,206 SF
- Available: 16,200 SF
- Divisible to: 5,400 SF units
- Office: Finish to suit
- Clear height: 22'
- Car parking: 84 stalls allocated to building
- Power: 1,200A, 208/480 volt, 3 phase
- Loading: (0) DH doors
(6) GL doors