



**CUSHMAN &
WAKEFIELD**

FOR SALE - PADS

Mountain View Corridor & Anthem Park Blvd / Herriman, Utah

**Pads for sale on
Mountain View Corridor,
future on/off ramp with
access off of Anthem
Park blvd & Herriman
Main Street**

Property Highlights

- Adjacent to new Walmart Super Center
- Great visibility from Mountain View Corridor
- Near Herriman High School & new middle school
- 0.89 - 2.55 acres available

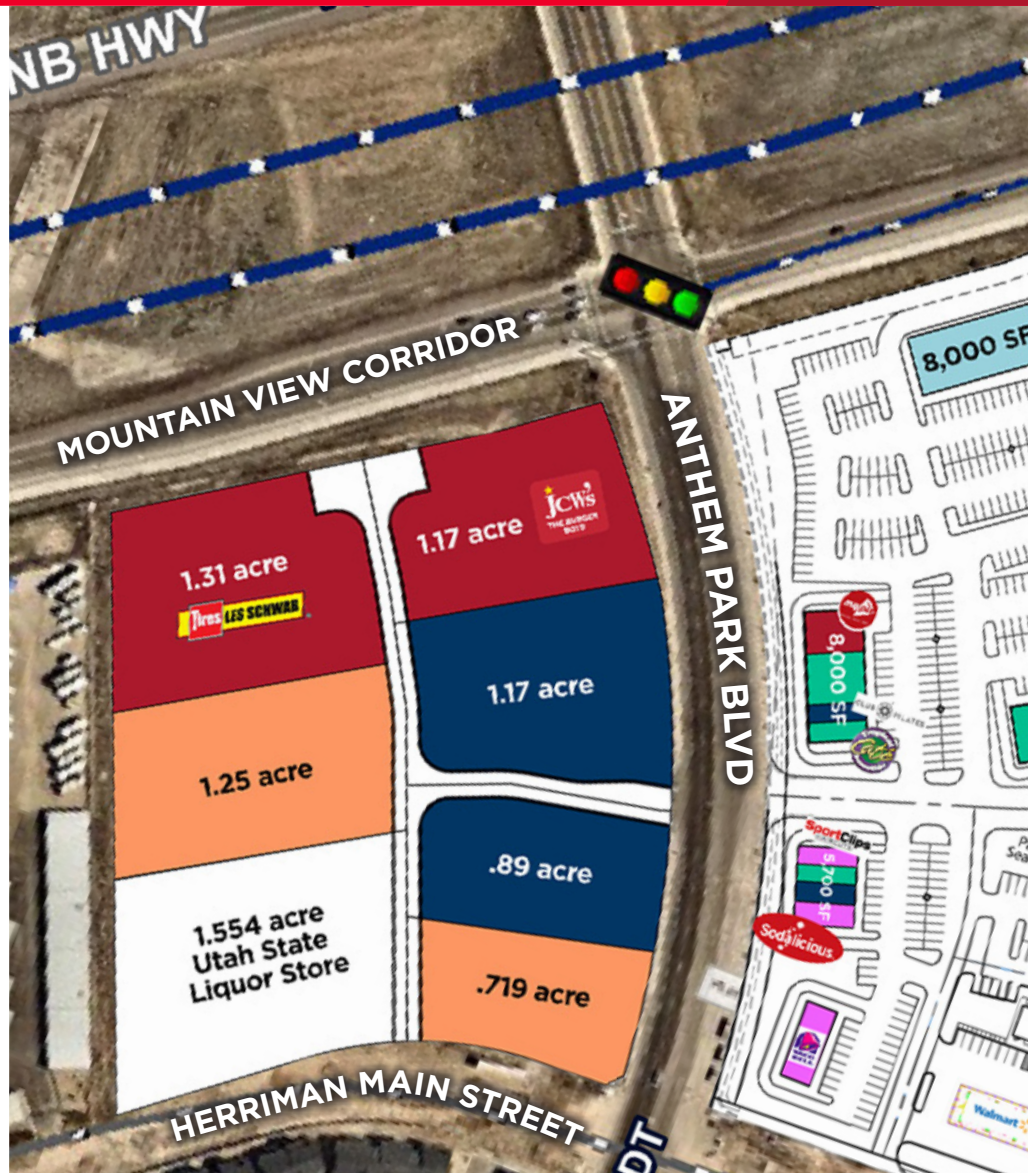

John Owens
Executive Director
+1 801 303 5435
john.owens@cushwake.com

Nick Clark
Senior Director
+1 801 303 5430
nick.clark@cushwake.com

Jonathan Owens
Director - Retail
+1 801 303 5509
jonathan.owens@cushwake.com

170 South Main Street, Suite 1600
Salt Lake City, UT 84101
Main +1 801 322 2000
Fax +1 801 322 2040
cushmanwakefield.com



Mountain View Corridor & Anthem Park Blvd / Herriman, Utah

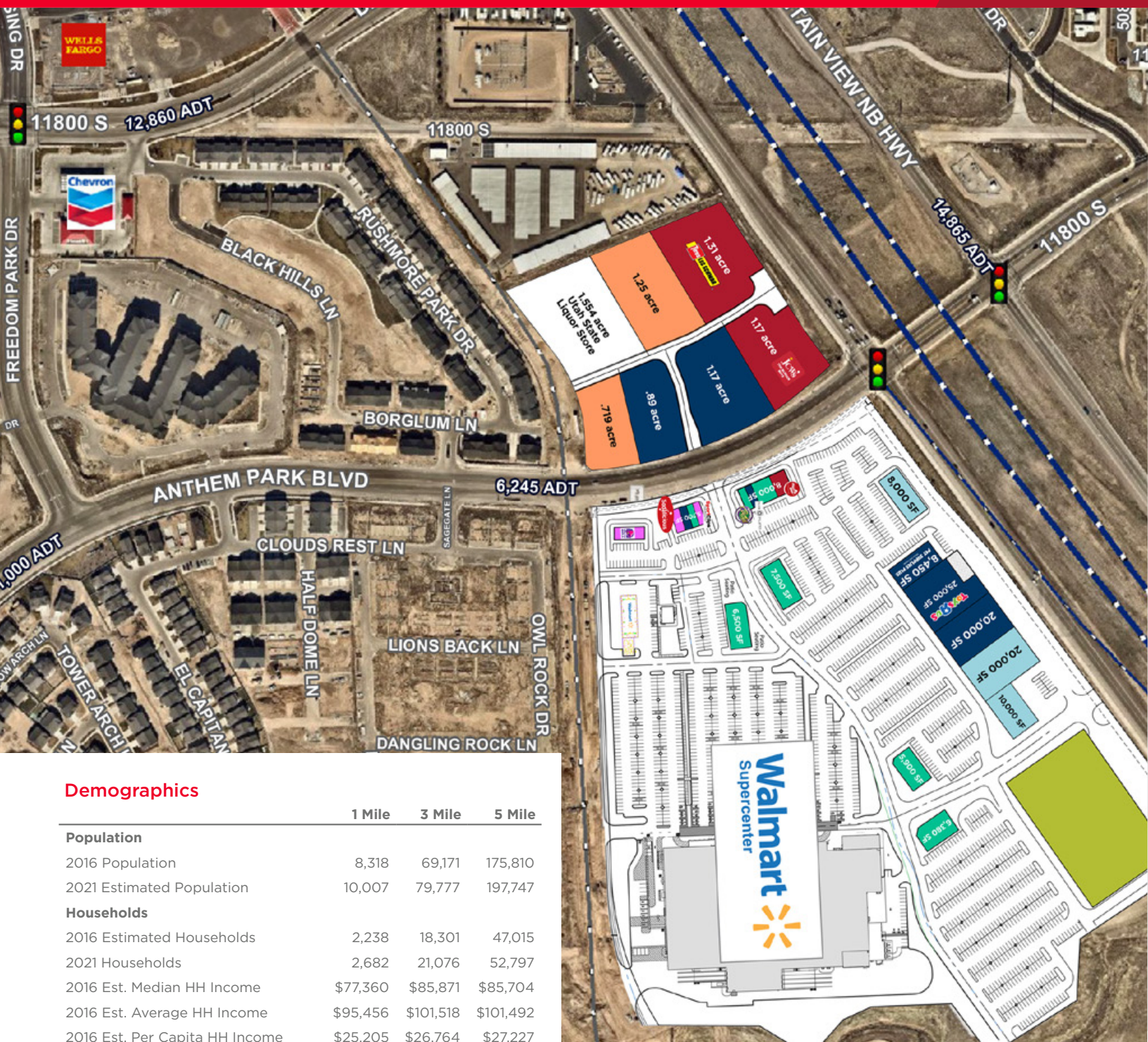

	1 Mile	3 Mile	5 Mile
Population			
2016 Population	8,318	69,171	175,810
2021 Estimated Population	10,007	79,777	197,747
Households			
2016 Estimated Households	2,238	18,301	47,015
2021 Households	2,682	21,076	52,797
2016 Est. Median HH Income	\$77,360	\$85,871	\$85,704
2016 Est. Average HH Income	\$95,456	\$101,518	\$101,492
2016 Est. Per Capita HH Income	\$25,205	\$26,764	\$27,227

Executive Director
+1 801 303 5435
john.owens@cushwake.com

Senior Director
+1 801 303 5430
nick.clark@cushwake.com

Director - Retail
+1 801 303 5509
jonathan.owens@cushwake.com

170 South Main Street, Suite 1600
Salt Lake City, UT 84101
Main +1 801 322 2000
Fax +1 801 322 2040
cushmanwakefield.com