



**CUSHMAN &  
WAKEFIELD**  
Commerce

FOR SALE

**1991 West Parkway Blvd**  
West Valley City, UT

SALE PRICE REDUCED!



## Property Highlights

- 16,000 SF Total
  - 8,000 SF Office
  - 8,000 SF R&D Warehouse
- Two (2) 10' x 10' ground level doors
- 12' ceiling
- 41 employee parking stalls
- 400 amps, 240 Volt, 3-phase power
- 10KVA backup generator
- Built in 1990 (roof recently replaced)
- UTOPIA available to the building
- Full HVAC through the entire building
- Tax ID # 15-22-352-001
- Zoned manufacturing
- Full HVAC through the entire building
- UTOPIA available to the building
- Built in 1990 (roof recently replaced)
- 4 separate meters, could be divided into 4 units
- Convenient access to/from I-215 and Hwy 201 via Redwood Road
- Walking distance (0.4 miles) to the Redwood Junction TRAX station

**Sales Price: ~~\$1,472,000 (\$92.00 PSF)~~**

**Price Reduced: \$1,200,000 (\$75.00 PSF)**

**Jeremy Terry**  
Industrial Specialist  
+1 801 303 5561  
jterry@comre.com

**Travis Healey SIOR**  
Senior Director  
+1 801 303 5565  
thealey@comre.com

**Tom Freeman, SIOR**  
Executive Director  
+1 801 303 5449  
tfreeman@comre.com

170 South Main Street Suite 1600  
Salt Lake City, UT 84101  
Main +1 801 322 2000  
Fax +1 801 322 2040  
**comre.com**

*Independently Owned and Operated / A Member of the Cushman & Wakefield Alliance*

Cushman & Wakefield Copyright 2016. No warranty or representation, express or implied, is made to the accuracy or completeness of the information contained herein, and same is submitted subject to errors, omissions, change of price, rental or other conditions, withdrawal without notice, and to any special listing conditions imposed by the property owner(s). As applicable, we make no representation as to the condition of the property (or properties) in question.  
(path: \\delphi\gigas\1 - Projects\Terry, J\1 - Flyers\1991WestParkwayBlvd\_Flyer)



**CUSHMAN &  
WAKEFIELD**  
Commerce

FOR SALE

**1991 West Parkway Blvd**

West Valley City, UT

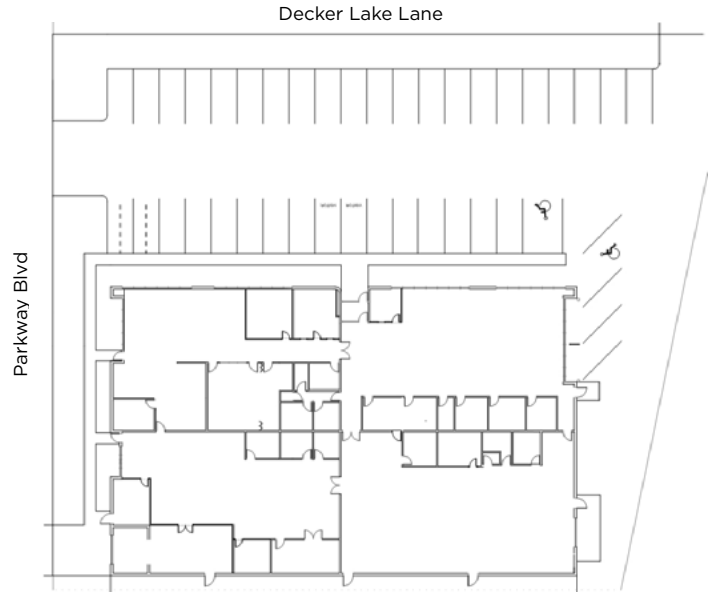

**Jeremy Terry**  
Industrial Specialist  
+1 801 303 5561  
jterry@comre.com

**Travis Healey SIOR**  
Senior Director  
+1 801 303 5565  
thealey@comre.com

**Tom Freeman, SIOR**  
Executive Director  
+1 801 303 5449  
tfreeman@comre.com

170 South Main Street Suite 1600  
Salt Lake City, UT 84101  
Main +1 801 322 2000  
Fax +1 801 322 2040  
**comre.com**

*Independently Owned and Operated / A Member of the Cushman & Wakefield Alliance*

Cushman & Wakefield Copyright 2016. No warranty or representation, express or implied, is made to the accuracy or completeness of the information contained herein, and same is submitted subject to errors, omissions, change of price, rental or other conditions, withdrawal without notice, and to any special listing conditions imposed by the property owner(s). As applicable, we make no representation as to the condition of the property (or properties) in question.  
(path: \\delphi\gigas\1 - Projects\Terry, J\1 - Flyers\1991WestParkwayBlvd\_Flyer)