



**CUSHMAN &
WAKEFIELD**
Commerce

FOR SUBLEASE

Eastgate Office Park - Bldg 1

15325 SE 30th Pl / Bellevue, WA



2,757 SF Office Space For Sublease

Property Highlights

- Sublease through 9/30/21
- \$30.00/RSF Gross
- Available within 30 days
- Suite 300
- Furniture and cabling available
- Large campus with multiple buildings
- Park-like setting
- On-site fitness center & conference center
- Excellent access to I-90

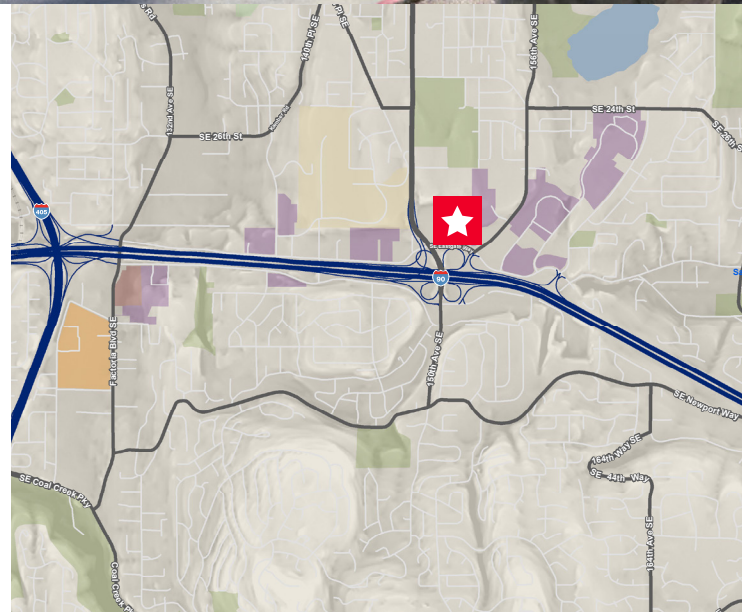

Trevor Youngren

Director
+1 206 521 0241
trevor.youngren@comre.com

Andrew Toner

Associate
+1 206 521 0288
andrew.toner@comre.com

1420 5th Ave, Suite 2600
Seattle, WA
Main +1 206 682 0666
Fax +1 206 521 0298
comre.com

Independently Owned and Operated / A Member of the Cushman & Wakefield Alliance

Cushman & Wakefield Copyright 2017. No warranty or representation, express or implied, is made to the accuracy or completeness of the information contained herein, and same is submitted subject to errors, omissions, change of price, rental or other conditions, withdrawal without notice, and to any special listing conditions imposed by the property owner(s). As applicable, we make no representation as to the condition of the property (or properties) in question.



**CUSHMAN &
WAKEFIELD**
Commerce

FOR SUBLEASE

Eastgate Office Park - Bldg 1

15325 SE 30th Pl / Bellevue, WA

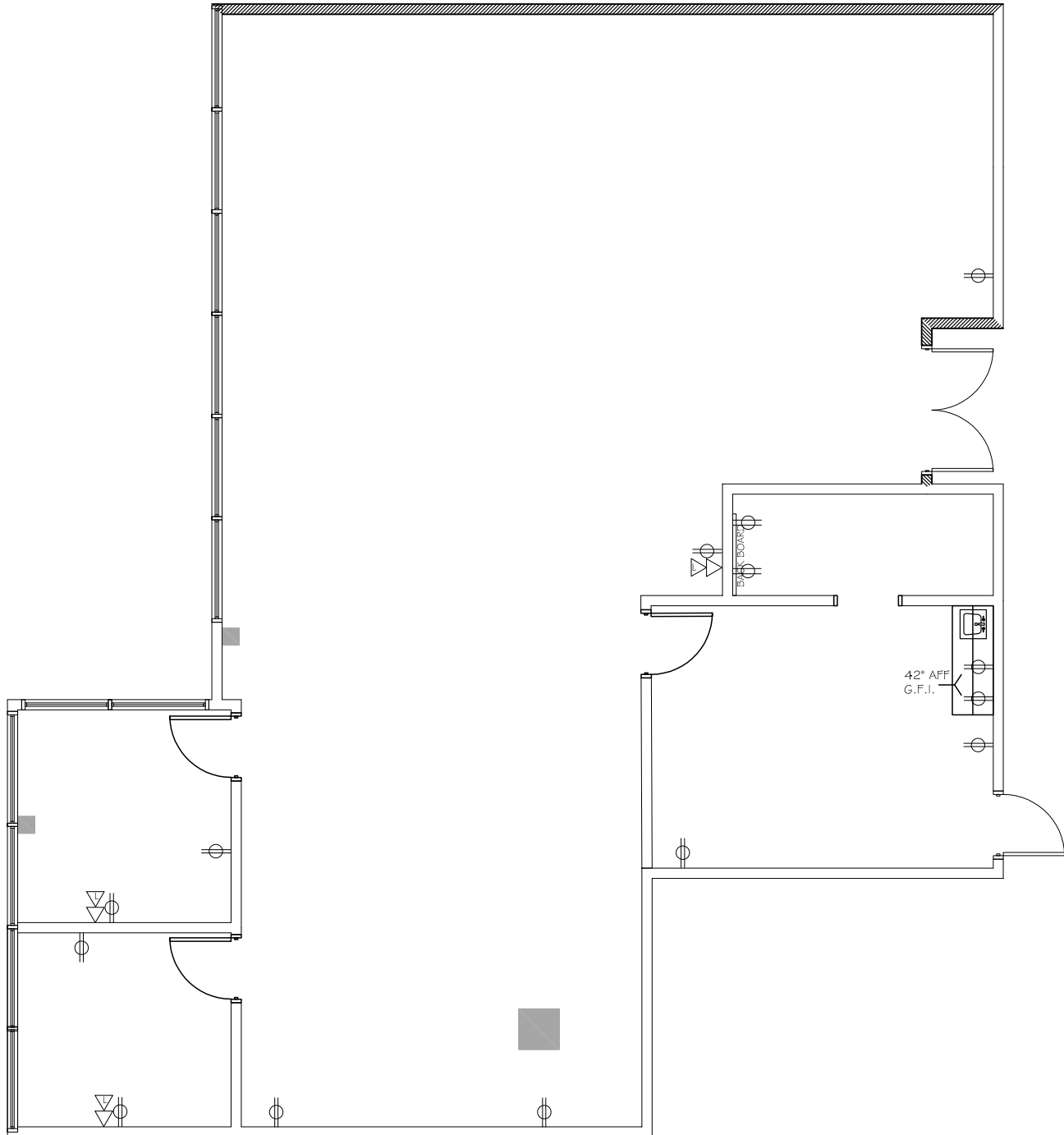

Trevor Youngren
Director
+1 206 521 0241
trevor.youngren@comre.com

Andrew Toner
Associate
+1 206 521 0288
andrew.toner@comre.com

1420 5th Ave, Suite 2600
Seattle, WA
Main +1 206 682 0666
Fax +1 206 521 0298
comre.com

Independently Owned and Operated / A Member of the Cushman & Wakefield Alliance

Cushman & Wakefield Copyright 2017. No warranty or representation, express or implied, is made to the accuracy or completeness of the information contained herein, and same is submitted subject to errors, omissions, change of price, rental or other conditions, withdrawal without notice, and to any special listing conditions imposed by the property owner(s). As applicable, we make no representation as to the condition of the property (or properties) in question.