



**CUSHMAN &  
WAKEFIELD**  
Commerce

FOR SUBLEASE

## RH North Creek Business Center

11810 North Creek Parkway North  
Bothell, Washington 98011



### Property Highlights

- 21,500 RSF (divisible)
- \$15.00/SF, NNN
- Lease term through September 2018
- Available with 60 days notice
- Free parking at a ratio of 3.7/1,000 RSF
- Great option for a full building user
- Corporate neighbors include AT&T, Puget Sound Energy and Google
- Conveniently located near numerous amenities
- Recently renovated landscaping and building exterior
- Building signage available

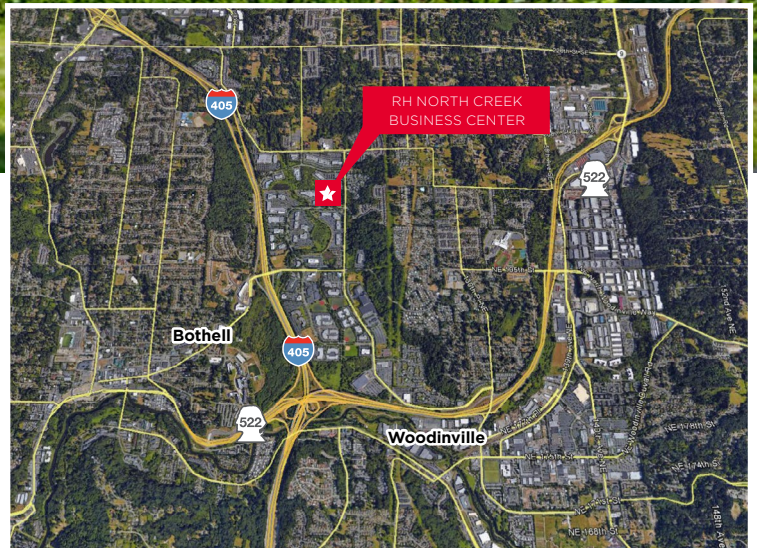

**Brian Toy**

Director  
425 201 1224  
Brian.Toy@comre.com

**Taylor Hudson**

Associate  
425 201 1205  
Taylor.Hudson@comre.com

10500 NE 8th Street, Suite 1125  
Bellevue, WA  
Main +1 425 455 4500  
Fax +1 425 453 5381  
**comre.com**

*Independently Owned and Operated / A Member of the Cushman & Wakefield Alliance*

Cushman & Wakefield Copyright 2015. No warranty or representation, express or implied, is made to the accuracy or completeness of the information contained herein, and same is submitted subject to errors, omissions, change of price, rental or other conditions, withdrawal without notice, and to any special listing conditions imposed by the property owner(s). As applicable, we make no representation as to the condition of the property (or properties) in question.



**CUSHMAN &  
WAKEFIELD**  
Commerce

FOR SUBLEASE

# RH North Creek Business Center

11810 North Creek Parkway North  
Bothell, Washington 98011

## Current Floor Plan

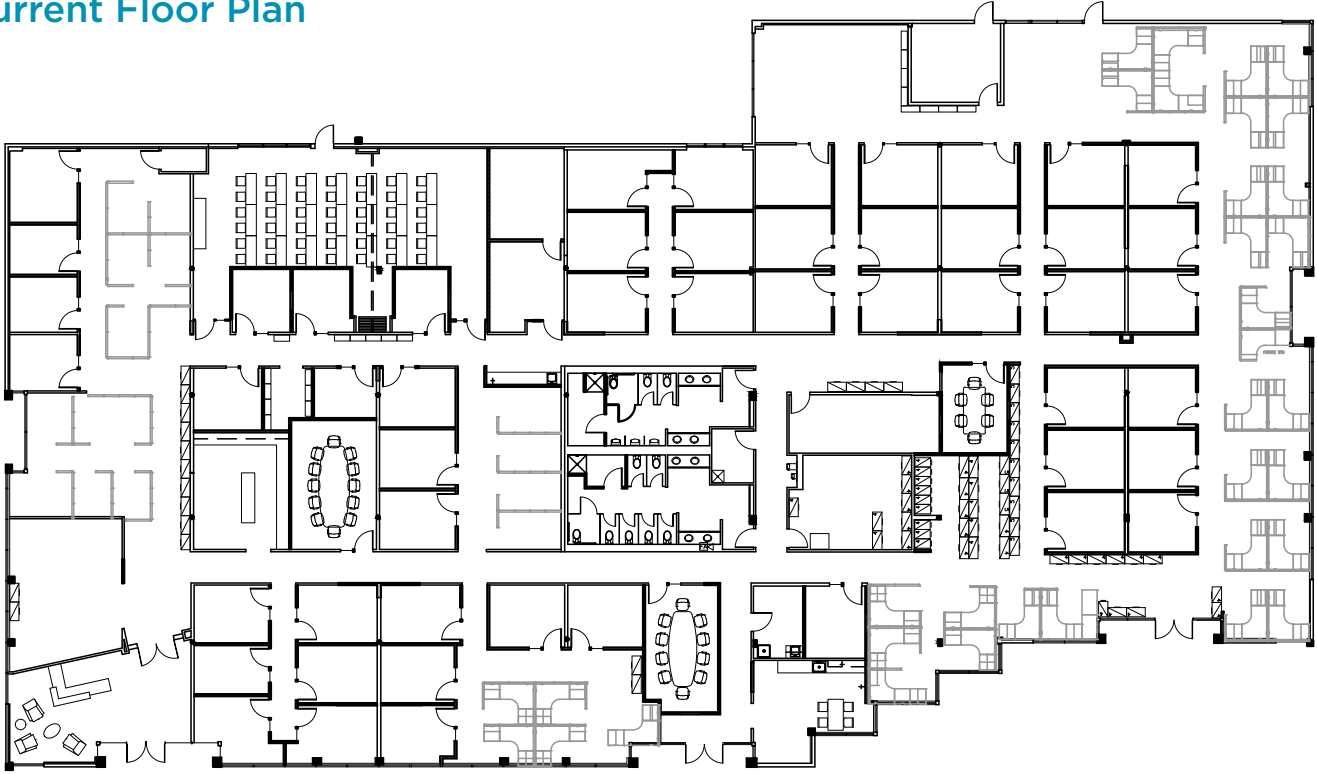

## Demising Plan

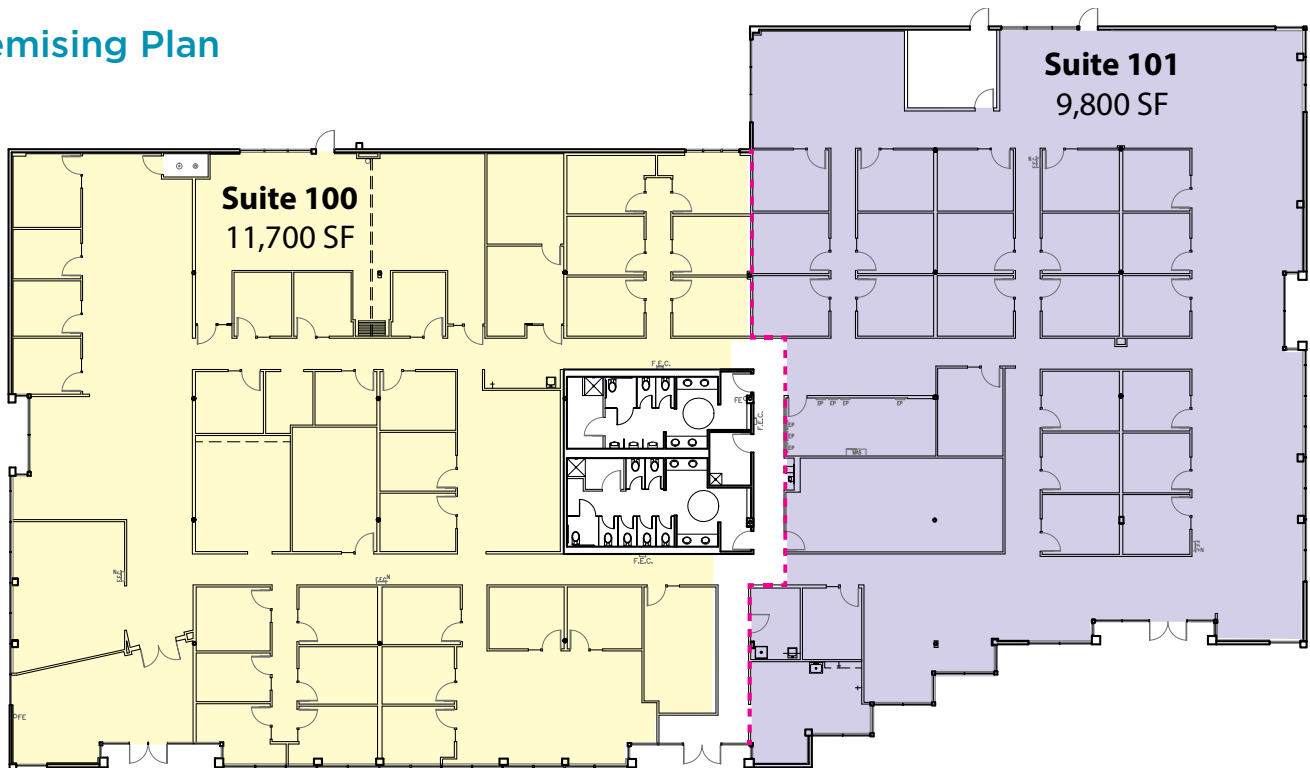





**CUSHMAN &  
WAKEFIELD**  
Commerce

FOR SUBLEASE

## RH North Creek Business Center

11810 North Creek Parkway North  
Bothell, Washington 98011



**Brian Toy**  
Director  
425 201 1224  
Brian.Toy@comre.com



**Taylor Hudson**  
Associate  
425 201 1205  
Taylor.Hudson@comre.com



10500 NE 8th Street, Suite 1125  
Bellevue, WA  
Main +1 425 455 4500  
Fax +1 425 453 5381  
**comre.com**

*Independently Owned and Operated / A Member of the Cushman & Wakefield Alliance*

Cushman & Wakefield Copyright 2015. No warranty or representation, express or implied, is made to the accuracy or completeness of the information contained herein, and same is submitted subject to errors, omissions, change of price, rental or other conditions, withdrawal without notice, and to any special listing conditions imposed by the property owner(s). As applicable, we make no representation as to the condition of the property (or properties) in question.





**CUSHMAN &  
WAKEFIELD**  
Commerce

FOR SUBLEASE

# RH North Creek Business Center

11810 North Creek Parkway North  
Bothell, Washington 98011

## NEARBY AMENITIES

### Restaurants:

Quiznos Sandwich Restaurants .4 mi  
Teriyaki Etc .4 mi  
Subway .4 mi  
Russell's .5 mi  
Parkside Deli .6 mi  
Garlic Jim's Pizza Bothell .9 mi  
Uanggratis .9 mi  
Dandy Dogs 1 mi  
Subway 1 mi  
Dairy Queen 1.3 mi  
Kozy Corner Cafe 1.4 mi

### Coffee:

Vanilla Sky Cafe .08 mi  
Lori's Deli & Espresso .2 mi  
Sonic8Forum .5 mi  
Starbucks .9 mi  
Common Grounds Coffee Shop 1.1 mi  
The Den Coffeehouse 1.3 mi  
La Bella Bean Espresso 1.4 mi  
Coffee Ladro 1.4 mi  
QFC 1.4 mi  
Alexa's Cafe & Catering 1.5 mi  
BREW Coffee Beer and Wine 1.5 mi  
Mercurys Coffee Co 1.5 mi  
Rockin'shots Espresso 1.6 mi

### Groceries:

Madelca Foods .6 mi  
Bothell Deli & Grocery 1.3 mi  
La Princesa Market 1.4 mi  
Super Lucky Food Stores 1.4 mi  
Garden Fresh Foods 1.5 mi  
QFC 1.5 mi  
Costco 1.6 mi  
Market Pacers 1.6 mi  
Wax Orchards 1.6 mi  
Hain Refridgerated Foods 1.9 mi  
Woodinville Farmers Market 1.9 mi  
Bothell Farmers Market 1.9 mi  
Albertsons 2 mi  
Fred Zante Farm & Market 2 mi

### Parks:

Rotary Park 1.1 mi  
William Penn Park 1.1 mi  
Stipek Park 1.3 mi  
Mary Murphey Park 1.4 mi  
Wilmot Gateway Park 1.6 mi  
Woodinville Athletic Fields 1.6 mi  
Bothell Landing Park 1.6 mi  
DeYoung Park 1.7 mi  
Woodin Creek Park 1.8 mi  
Gold Creek Park 2.9 mi  
Northshore Athletic Fields 3.1 mi  
Inglemoor County Park 3.3 mi

### Shopping:

David Morgan LLC .1 mi  
Madeline Mittens 1 mi  
Taymac & Co LLC 1.3 mi  
Kische USA 1.3 mi  
See Kai Run 1.4 mi  
Filson 1.4 mi  
MoonDog Embroidery 1.4 mi  
Alligator Purse 1.4 mi  
Moments to Treasure Bridal 1.4 mi  
Paul Richards Clothing 1.4 mi  
Discount Divas 1.5 mi  
Stitch & Print 1.5 mi  
Jacksons Food 1.5 mi  
The Gift Horse Saddlery 1.5 mi  
Party City 1.6 mi

### Entertainment:

Bothell Historical Museum 1.6 mi  
AMC Loews Woodinville 12 1.7 mi  
AMC Woodinville 12 1.7 mi  
The Woodhouse Wine Estates 2.6 mi  
Redbox 2.7 mi  
Totem Lake Cinemas 4.2 mi

**Brian Toy**  
Director  
425 201 1224  
Brian.Toy@comre.com

**Taylor Hudson**  
Associate  
425 201 1205  
Taylor.Hudson@comre.com

10500 NE 8th Street, Suite 1125  
Bellevue, WA  
Main +1 425 455 4500  
Fax +1 425 453 5381  
**comre.com**

*Independently Owned and Operated / A Member of the Cushman & Wakefield Alliance*

Cushman & Wakefield Copyright 2015. No warranty or representation, express or implied, is made to the accuracy or completeness of the information contained herein, and same is submitted subject to errors, omissions, change of price, rental or other conditions, withdrawal without notice, and to any special listing conditions imposed by the property owner(s). As applicable, we make no representation as to the condition of the property (or properties) in question.