

Property Highlights

- Sales Price: \$2,595,000
- Reason for sale: Owner's pending retirement
- Lot Size: 0.85 Acres
- Parking Stalls: 41 Stalls
- Building Size: 37,285 SF
- Levels: Two/Three
- APN#: 16-28-351-025  
16-28-351-024
- Owner will consider lease of entire building to qualified tenant. Call for details

Demographics

	1 Mile	3 Mile	5 Mile
<b>Population</b>			
2015 Estimated Population	18,436	153,534	317,882
2020 Projected Population	19,167	160,675	332,718
<b>Households</b>			
2015 Estimated Households	7,806	62,866	128,069
2020 Projected Households	8,138	66,092	134,949
2015 Est. Median HH Income	\$57,541	\$54,539	\$51,351
2015 Est. Average HH Income	\$71,589	\$70,038	\$69,393
2015 Est. Per Capita HH Income	\$30,245	\$28,888	\$28,515

Source: U.S. Census Bureau, Census 2010 Data. Esri forecasts for 2015 and 2020.

Paul Westenskow  
Senior Director  
+1 801 303 5557  
pwestenskow@comre.com

Kyle McMullin  
Senior Director  
+1 801 303 5480  
kcmcmullin@comre.com

170 South Main Street Suite 1600  
Salt Lake City, UT 84101  
Main +1 801 322 2000  
Fax +1 801 322 2040  
comre.com

Paul Westenskow  
Senior Director  
+1 801 303 5557  
pwestenskow@comre.com

Kyle McMullin  
Senior Director  
+1 801 303 5480  
kcmcmullin@comre.com

170 South Main Street Suite 1600  
Salt Lake City, UT 84101  
Main +1 801 322 2000  
Fax +1 801 322 2040  
comre.com

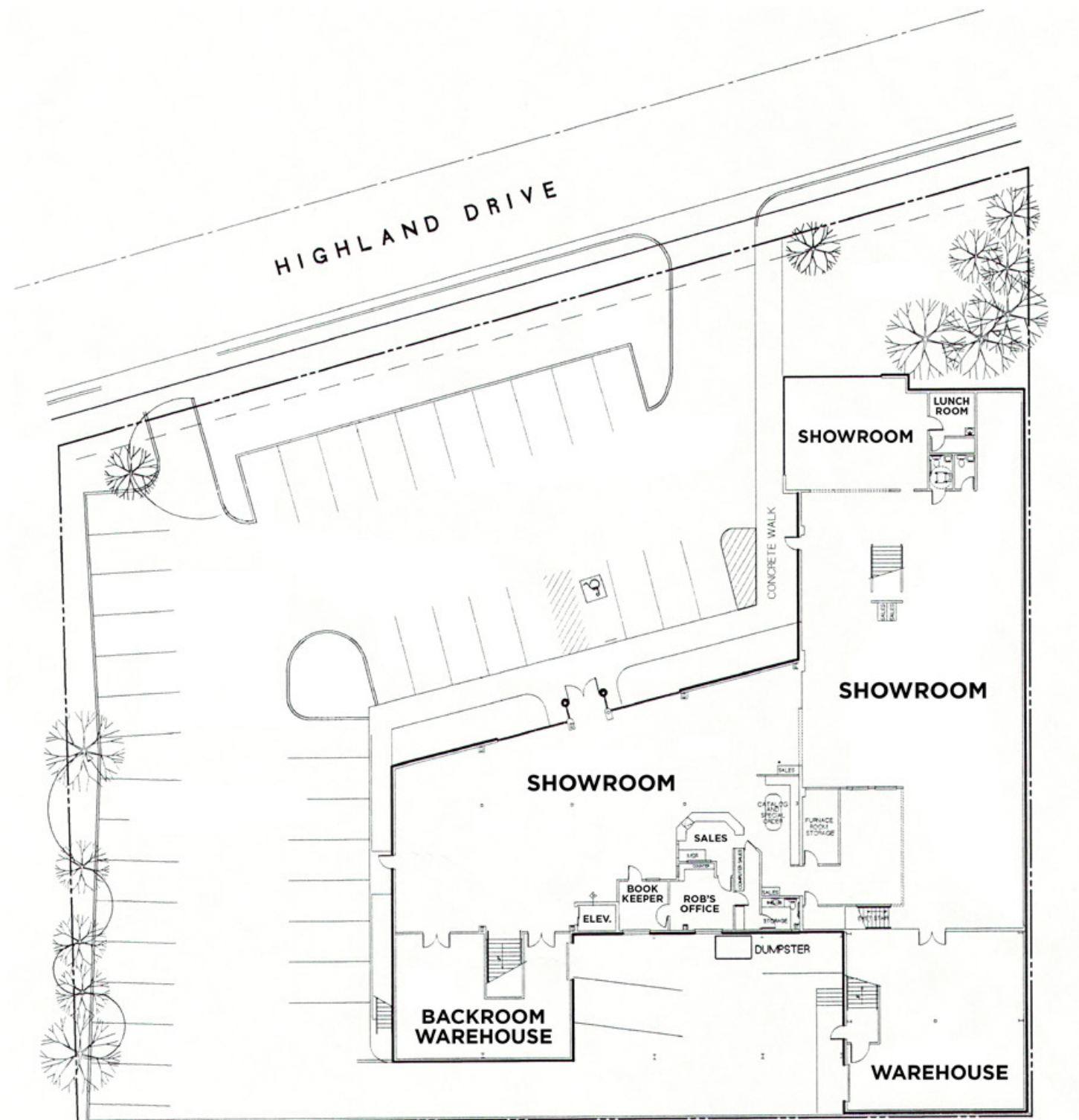

**2nd Floor**



**3rd Floor**

