



**CUSHMAN &
WAKEFIELD**
Commerce

FOR LEASE

180 East 2100 South
Salt Lake City, Utah

BOLLINGER BUILDING



Property Highlights

- Lease Rate: \$11.00 / RSF, Full Service
- Available: Suite 203 - 863 RSF
- Parking: 10 stalls per 1,000 RSF
- Centrally located near State & 2100 South
- Across from Salt Lake County Complex
- Excellent freeway access to I-80, I-15 and 201
- Close proximity to TRAX



Ron Bollinger
Industrial / Investment Specialist
+1 801 303 5456
rbollinger@comre.com

Camron Carpenter
Director
+1 801 303 5457
ccarpenter@comre.com

170 South Main Street, Suite 1600
Salt Lake City, UT 84101
Main +1 801 322 2000
Fax +1 801 322 2040
comre.com

Independently Owned and Operated / A Member of the Cushman & Wakefield Alliance

Cushman & Wakefield Copyright 2016. No warranty or representation, express or implied, is made to the accuracy or completeness of the information contained herein, and same is submitted subject to errors, omissions, change of price, rental or other conditions, withdrawal without notice, and to any special listing conditions imposed by the property owner(s). As applicable, we make no representation as to the condition of the property (or properties) in question. (path: G:\1 - Projects\Bollinger, Ron\1 - Flyers\180e2100s-STE-100)



**CUSHMAN &
WAKEFIELD**
Commerce

FOR LEASE

180 East 2100 South
Salt Lake City, Utah

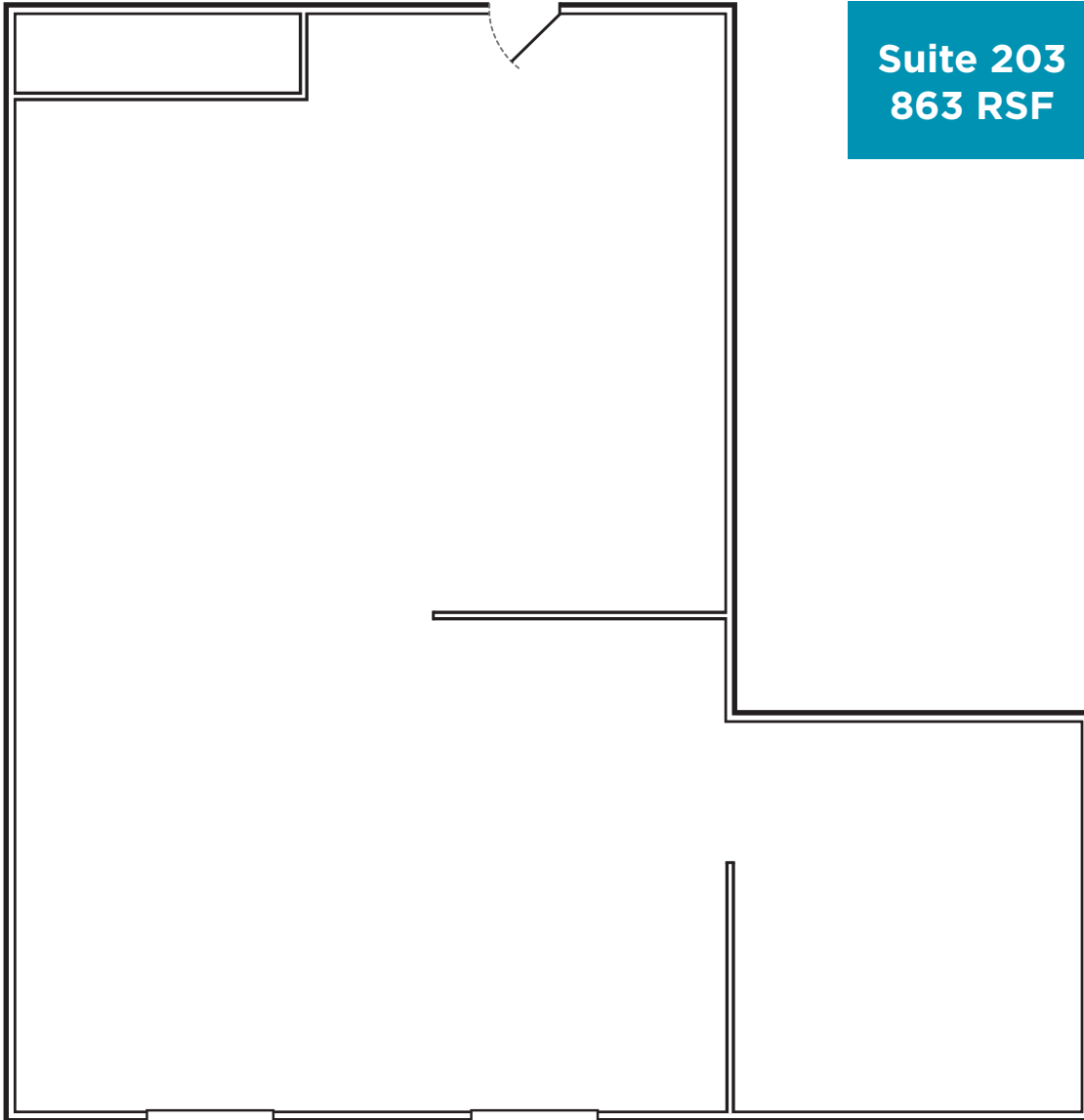

Suite 203
863 RSF

Ron Bollinger
Industrial / Investment Specialist
+1 801 303 5456
rbollinger@comre.com

Camron Carpenter
Director
+1 801 303 5457
ccarpenter@comre.com

170 South Main Street, Suite 1600
Salt Lake City, UT 84101
Main +1 801 322 2000
Fax +1 801 322 2040
comre.com

Independently Owned and Operated / A Member of the Cushman & Wakefield Alliance

Cushman & Wakefield Copyright 2016. No warranty or representation, express or implied, is made to the accuracy or completeness of the information contained herein, and same is submitted subject to errors, omissions, change of price, rental or other conditions, withdrawal without notice, and to any special listing conditions imposed by the property owner(s). As applicable, we make no representation as to the condition of the property (or properties) in question. (path: G:\1 - Projects\Bollinger, Ron\1 - Flyers\180e2100s-STE-100)