

CentrePointe Business Park

1865 West 2100 South / Salt Lake City, Utah

CentrePointe Business Park

1865 West 2100 South / Salt Lake City, Utah

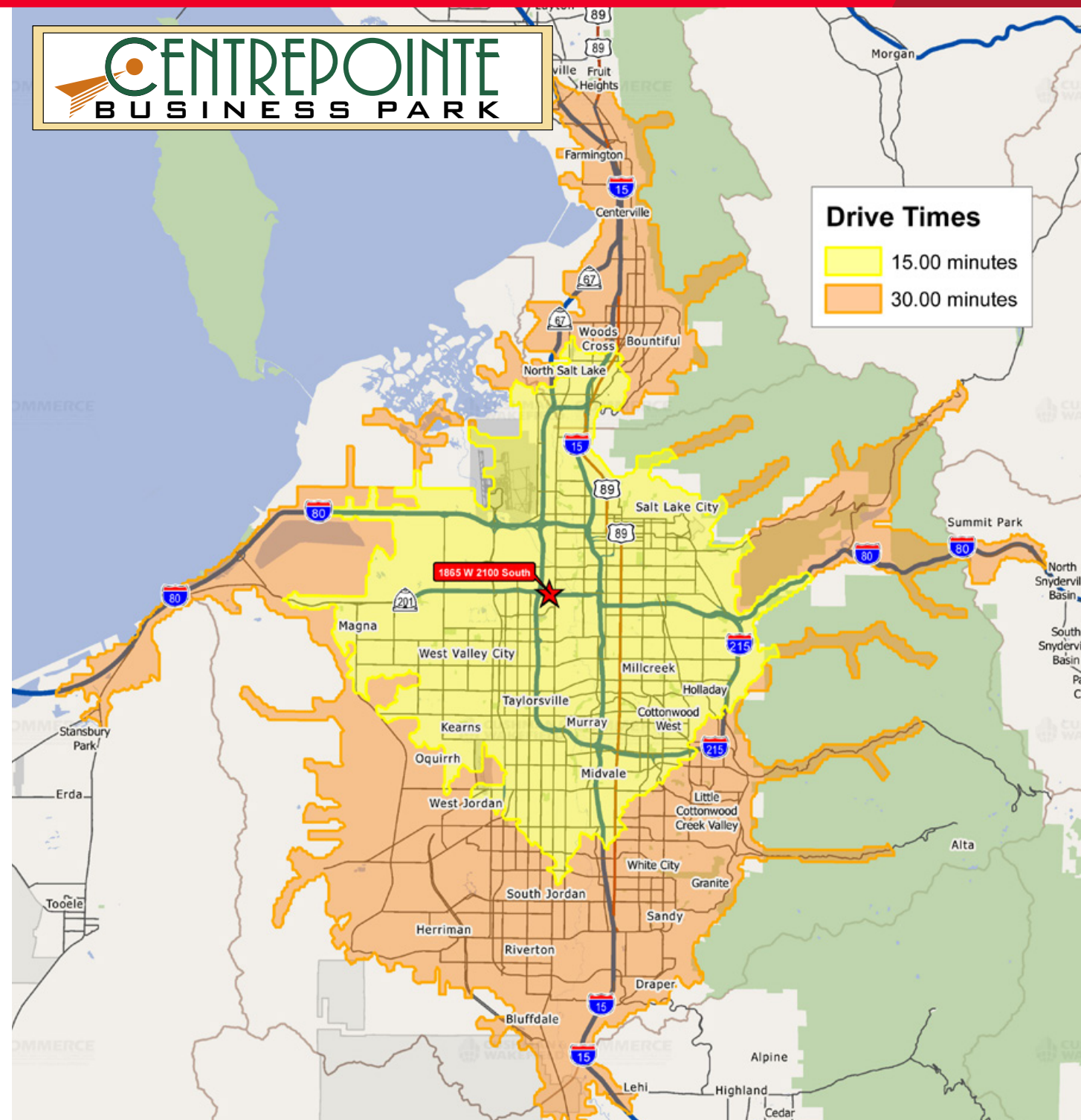

Anne Smart, sior
Director
+1 801 303 5553
asmart@comre.com

Chris Kirk, sior
Executive Director
+1 801 303 5495
ckirk@comre.com

170 South Main Street Suite 1600
Salt Lake City, UT 84101
Main +1 801 322 2000
Fax +1 801 322 2040
comre.com

Independently Owned and Operated / A Member of the Cushman & Wakefield Alliance

Cushman & Wakefield Copyright 2015. No warranty or representation, express or implied, is made to the accuracy or completeness of the information contained herein, and same is submitted subject to errors, omissions, change of price, rental or other conditions, withdrawal without notice, and to any special listing conditions imposed by the property owner(s). As applicable, we make no representation as to the condition of the property (or properties) in question.

(path: G:\1 - Projects\Smart, A\1 - Flyers\Centrepointe Business Park\2014\CentrePointe_Lease_flyer)



4% TO PROCURING BROKER*

90 DAYS FREE RENT*

**10,080 RSF available in Building A.
Ready for TI Office/Lab/Warehouse.**

Property Highlights

- Lease Rate: \$21.00 Full Service (excluding janitorial)
- First Floor: 10,080 RSF
- Ample Parking
- Class A lobby and office finishes
- Natural light for office and lab areas
- 13' - 18' clear height
- Increased water capacity
- Oversized drainage and sewer lines
- Specialized exhaust requirement accommodations
- Access for specialized piping, ducts and conduits

* When we get a deal underway in Oct 2016 with occupancy in Jan and commencement in April 2017 (Jan - Mar free rent)

Anne Smart, sior
Director
+1 801 303 5553
asmart@comre.com

Chris Kirk, sior
Executive Director
+1 801 303 5495
ckirk@comre.com

170 South Main Street Suite 1600
Salt Lake City, UT 84101
Main +1 801 322 2000
Fax +1 801 322 2040
comre.com

Independently Owned and Operated / A Member of the Cushman & Wakefield Alliance





1st Floor Plan

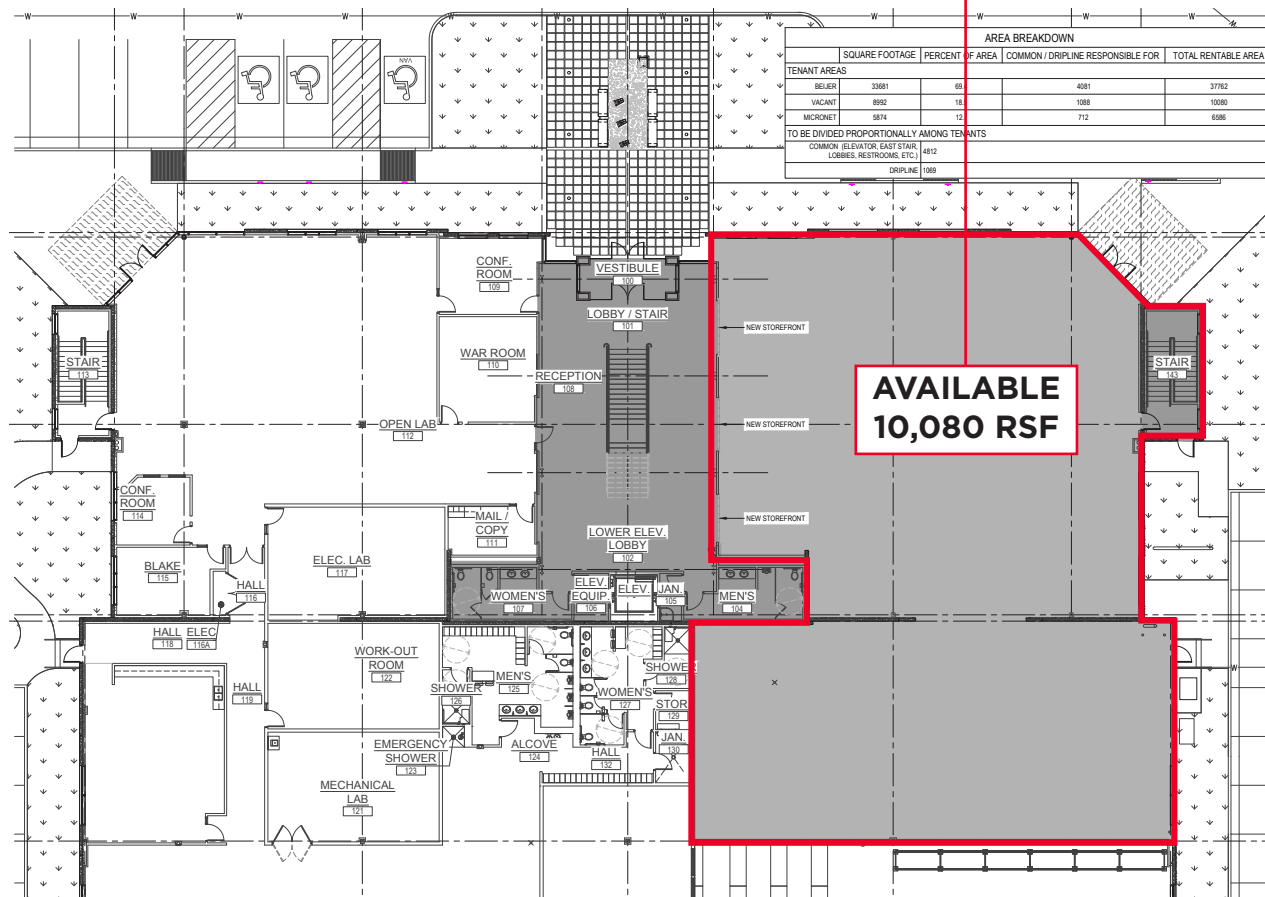

Site Plan

