

**Now Leasing Building C & D**  
**125,867 SF Building**  
**Divisible to 15,000 SF**



Office / Research & Development Campus  
 1865-1895 West 2100 South  
 Salt Lake City, Utah



#### Robust Life Sciences Industry

Utah Science Technology & Research (USTAR) Focus Areas: <sup>7</sup>

- BIODEVICE AND BIOPHARMA
- NANOTECHNOLOGY
- ENERGY
- MEDICAL IMAGING AND BRAIN MEDICINE
- VISUALIZATION TECHNOLOGY

Anne Smart, SIOR  
 801.322.2000  
 asmart@comre.com

Chris Kirk, SIOR  
 801.303.5495  
 ckirk@comre.com



1. Source: Pollina Corporate Real Estate, Inc. 2. Source: Forbes Magazine 3. Source: Forbes Magazine 4. Source: Ewing Marion Kauffman Foundation 5. Source: US Department of Labor 6. Source: Site Selection magazine 7. Utah Governor's Office of Economic Development



Building A

Fully Leased

Building B

Fully Leased

Building C & D

Total Size: 125,867 Sq. Ft.

Building C: 64,990 Sq. Ft.

Building D: 60,870 Sq. Ft.

Office R & D Information

High Profile, Contemporary Architecture

Significant Interstate & Highway Visibility

"Class A" Lobby and Office Finishes

Easy Access to all of Salt Lake County

Clean-Room Ready

Reinforced Flooring

Increased Water Supply Capacity

Oversized Drainage and Sewer Lines

Specialized Exhaust Requirement Accommodations

Emergency Generator Pad

Access for Specialized Piping, Ducts and Conduits

Natural Light for Office and Lab Areas

1<sup>st</sup> Floor: 13' Clear Height

2<sup>nd</sup> Floor: 12' Clear Height

Dock High and Ground Level Doors

Fully Secured Site



	BUILDING FOOTPRINT	COMMON AREA/BUILDING	1ST FLOOR OFFICE/R&D	2ND FLOOR OFFICE/R&D	TOTAL BUILDING SIZE	MINIMUM TENANT OCCUPANCY (INCLUDES PROPORTIONATE COMMON SPACE)
Building C	32,475	9,319	32,475	32,515	64,990	12,145 s.f.
Building D	30,367	9,346	30,367	30,503	60,870	15,334 s.f.
Building C & D	62,842	18,665	62,842	63,018	125,860	N/A

Easy access to Interstates 15 & 215, State Route 201 and Bangerter Highway

CentrePointe Business Park offers the infrastructure required to achieve long-term financial efficiency

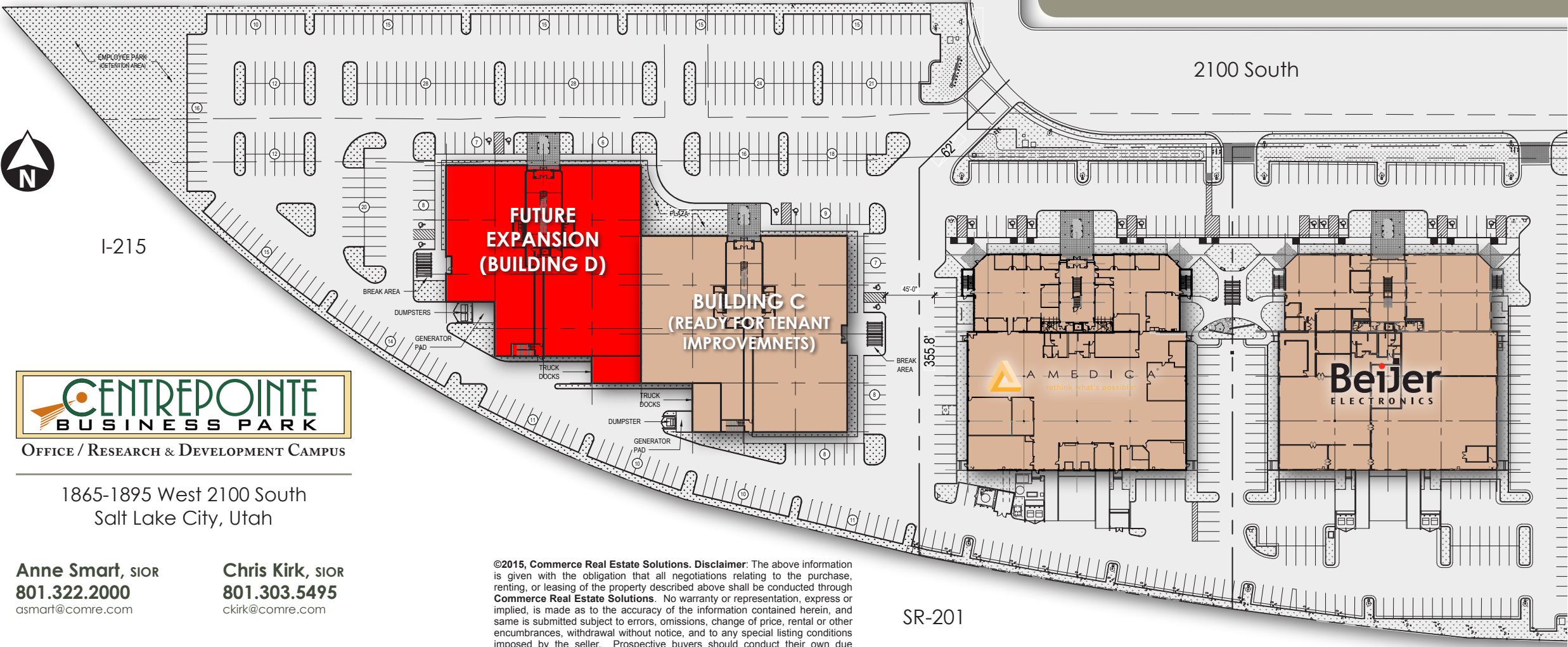

1865-1895 West 2100 South  
Salt Lake City, Utah

Anne Smart, SIOR  
801.322.2000  
asmart@comre.com

Chris Kirk, SIOR  
801.303.5495  
ckirk@comre.com

©2015, Commerce Real Estate Solutions. Disclaimer: The above information is given with the obligation that all negotiations relating to the purchase, renting, or leasing of the property described above shall be conducted through Commerce Real Estate Solutions. No warranty or representation, express or implied, is made as to the accuracy of the information contained herein, and same is submitted subject to errors, omissions, change of price, rental or other encumbrances, withdrawal without notice, and to any special listing conditions imposed by the seller. Prospective buyers should conduct their own due diligence. Some aerial photography by DigitalGlobe or Aerials Express. path: M:\1 - Projects\Smart, A\1 - Flyers\Centrepointe Business Park\2012\_11x17Update

