



**CUSHMAN &
WAKEFIELD**
Commerce

SHORT TERM FLEXIBLE SPACE

Yarrow Bay Quad 1 North

10604 NE 38th Pl, Kirkland, WA 98033



Short Term Flexible Space

Property Highlights

- Ideal for startups
- Space for 10 to 34 people
- Plug & Play space
- Available immediately
- Flexible 3-6 month terms
- High speed fiber connectivity and data/power redundancy
- Various furniture available
- Multiple configurations
- Abundant free parking
- Includes shared break room with complementary food & beverage
- Easy access to Seattle, Bellevue & Redmond

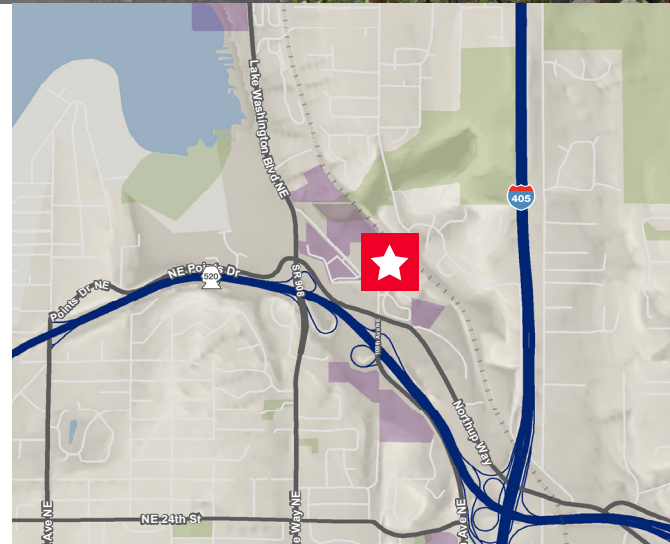

Trevor Youngren

Director
+1 206 521 0241
trevor.youngren@comre.com

Andrew Toner

Associate
+1 206 521 0288
andrew.toner@comre.com

1420 5th Ave, Suite 2600
Main +1 206 682 0666
Fax +1 206 521 0298
comre.com

Independently Owned and Operated / A Member of the Cushman & Wakefield Alliance

Cushman & Wakefield Copyright 2015. No warranty or representation, express or implied, is made to the accuracy or completeness of the information contained herein, and same is submitted subject to errors, omissions, change of price, rental or other conditions, withdrawal without notice, and to any special listing conditions imposed by the property owner(s). As applicable, we make no representation as to the condition of the property (or properties) in question.



**CUSHMAN &
WAKEFIELD**
Commerce

SHORT TERM FLEXIBLE SPACE

Yarrow Bay Quad 1 North

10604 NE 38th Pl, Kirkland, WA 98033

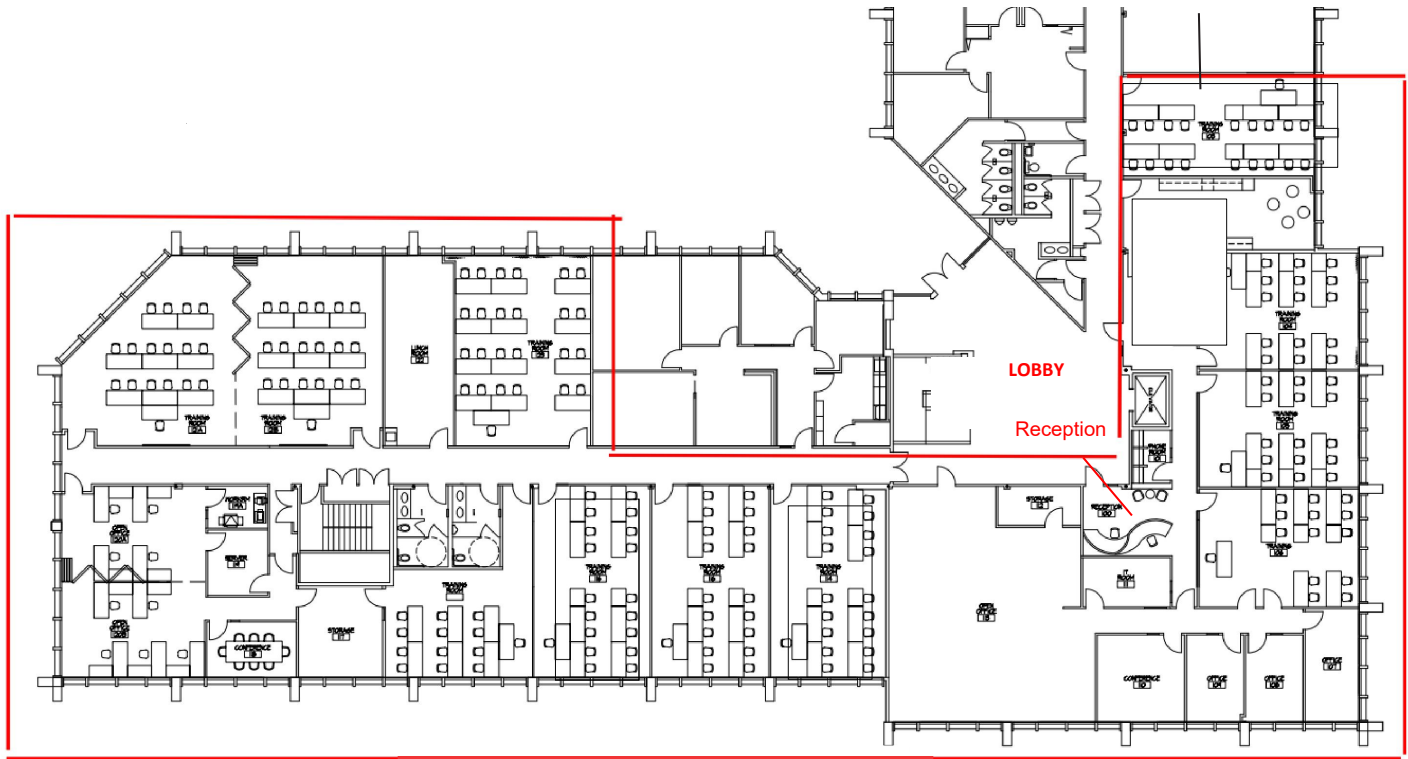

Trevor Youngren
Director
+1 206 521 0241
trevor.youngren@comre.com

Andrew Toner
Associate
+1 206 521 0288
andrew.toner@comre.com

1420 5th Ave, Suite 2600
Main +1 206 682 0666
Fax +1 206 521 0298
comre.com

Independently Owned and Operated / A Member of the Cushman & Wakefield Alliance

Cushman & Wakefield Copyright 2015. No warranty or representation, express or implied, is made to the accuracy or completeness of the information contained herein, and same is submitted subject to errors, omissions, change of price, rental or other conditions, withdrawal without notice, and to any special listing conditions imposed by the property owner(s). As applicable, we make no representation as to the condition of the property (or properties) in question.