

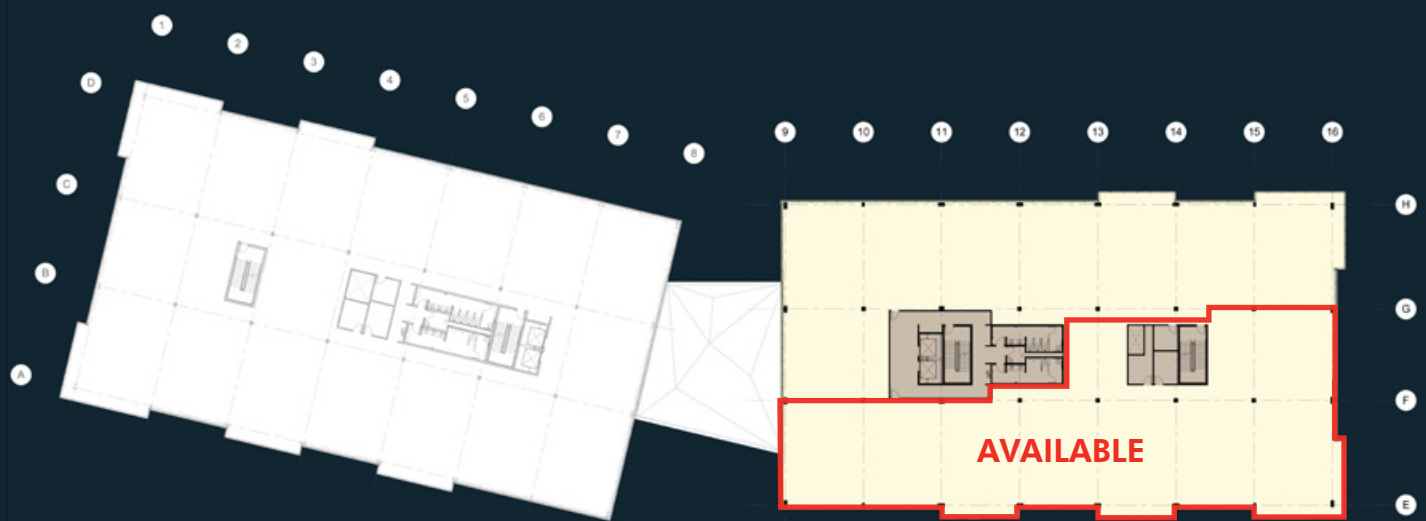

ANCESTRY CAMPUS | 1300 WEST TRAVERSE PARKWAY | LEHI, UT



**CUSHMAN &
WAKEFIELD**
Commerce



25,000 Sq. Ft. Floorplate



Floor Three



Location
1300 West Traverse Parkway
Lehi, Utah

Total Square Feet
200,000

Total Available Square Feet
10,000 - 38,000

**Lease Rate Reduced to
\$25.00 PSF, Full Service**

Parking
5/1,000 USF

T.I. Allowance
\$40.00 / USF

The Ancestry Campus features floor to ceiling glass, state-of-the-art HVAC systems, generous parking and incredible 360° views.

Your employees will appreciate the I-15 access, natural light, immediate public transit connectivity, secured bike lockers and indoor/outdoor amenity space.

In addition, the efficient core will allow for maximum flexibility as you plan for current and future needs.

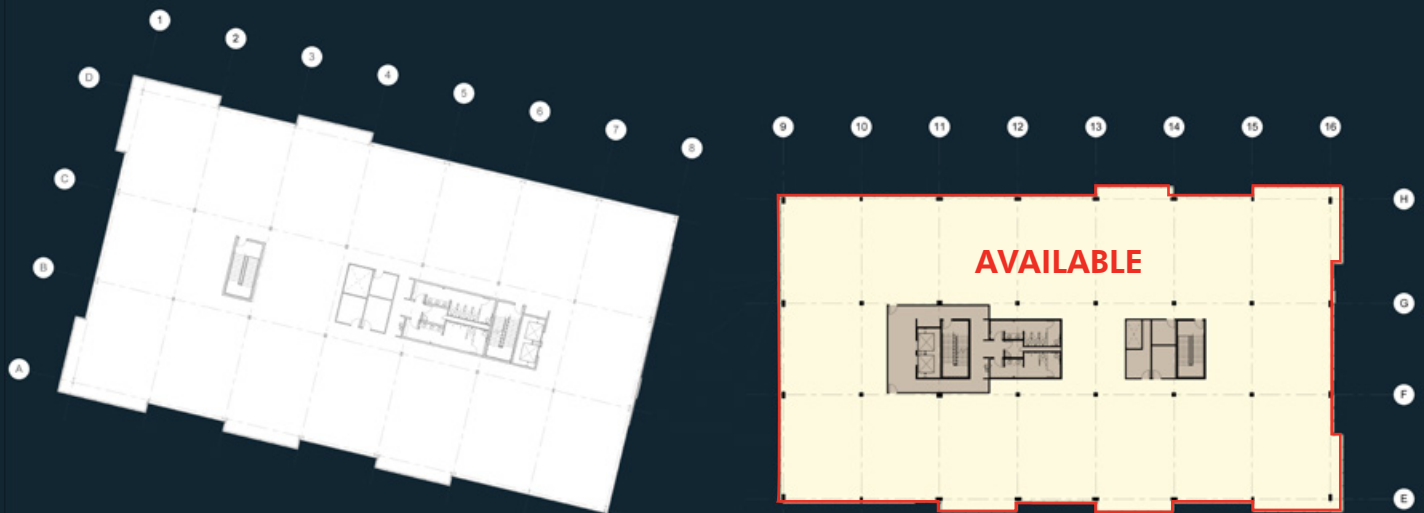

Floor Four

Jeff Rossi
Executive Director
801 303 5452
jrossi@comre.com

Tyson Fowler
Associate
801 303 5413
tfowler@comre.com



**CUSHMAN &
WAKEFIELD**
Commerce

TECH HIGHWAY

Lehi adds 350,000-square-feet with four major companies moving in - BY TESSA CURRY IN REAL ESTATE • STARTUP — MAY 26, 2015

Lehi is adding over 350,000-square-feet of new office space, the equivalent of six White Houses. With more and more companies announcing headquarters and offices in Lehi, the area is quickly becoming a hotspot for technology.

Ancestry.com, the family history company who have been headquartered in Provo for 30 years, are making the move to Lehi this year.

"Our move was more about talent than anything else," said Zach Pino Ancestry.com's VP of People and Places. "As we looked at spaces and looked around we didn't want to be cowboys or early settlers so a defining characteristic of where we wanted was a place that was reasonably established as far as amenities and plans."



HARMONS
GROCERY STORE
MAY 2016

Cabela's

Outlets

LEHI

← **SALT LAKE CITY**

Zupas	Del Taco	Dicky's
jDawgs	JCW's	Greek Souvlaki
Costa Vida	Carls Jr.	Subway
Popeyes	Zaxby's	Chick-fil-A
Chicken	Starbucks	Wendy's
Arby's	Firehouse	Taco Bell



PROVO →



LEHI FRONTRUNNER STATION



**THANKSGIVING POINT
GOLF COURSE**

ANCESTRY CAMPUS | 1300 WEST TRAVERSE PARKWAY | LEHI, UT

AREA AMENITIES

- Direct Access to Shuttle to UTA FrontRunner
- 0.2 miles to Harmons Grocery Store, opening May 2016.
- 10-15 minutes to retail stores and restaurants
- 1.1 miles to 20 additional dining options
- 0.8 mile to I-15

FOR ADDITIONAL INFORMATION, CONTACT:

JEFF ROSSI

Executive Director 801 303 5452 jrossi@comre.com

TYSON FOWLER

Associate 801 303 5413 tfowler@comre.com



**CUSHMAN &
WAKEFIELD**
Commerce

©2016, Commerce Real Estate Solutions. Disclaimer: The above information is given with the obligation that all negotiations relating to the purchase, renting, or leasing of the property described above shall be conducted through Commerce Real Estate Solutions. No warranty or representation, express or implied, is made as to the accuracy of the information contained herein, and same is submitted subject to errors, omissions, change of price, rental or other encumbrances, withdrawal without notice, and to any special listing conditions imposed by the seller. Prospective buyers should conduct their own due diligence. Some aerial photography by DigitalGlobe or Aerials Express. path: G:\I - Projects\Rossi, Jeff\I - Flyer\AncestryBuilding