



**CUSHMAN &
WAKEFIELD**
Commerce

FOR SUBLEASE

Vista Station 4

583 West Ebay Way / Draper, Utah

APPROX. 16,000 RSF



Property Highlights

- Approx. 16,000 RSF on the 5th floor
- \$26.50/SF Full Service
- 5/1,000 Parking
- Adjacent to Front Runner station
- +2 year lease term
- April 2016 occupancy
- New improvements, per floor plan



Jeff Rossi
Executive Director
+1 801 303 5452
jrossi@comre.com

Justin Bailey
Associate
+1 801 303 5493
jbailey@comre.com

170 South Main Street
Suite 1600
Salt Lake City, UT 84101
Main +1 801 322 2000
Fax +1 801 322 2040
comre.com

Independently Owned and Operated / A Member of the Cushman & Wakefield Alliance

Cushman & Wakefield Copyright 2015. No warranty or representation, express or implied, is made to the accuracy or completeness of the information contained herein, and same is submitted subject to errors, omissions, change of price, rental or other conditions, withdrawal without notice, and to any special listing conditions imposed by the property owner(s). As applicable, we make no representation as to the condition of the property (or properties) in question.
(path: G:\1 - Projects\Rossi, Jeff\1 - Flyer\VistaStation4\ VistaStation4)



**CUSHMAN &
WAKEFIELD**
Commerce

FOR SUBLEASE

Vista Station 4

583 West Ebay Way / Draper, Utah



FLOORPLAN

Furniture Not Included

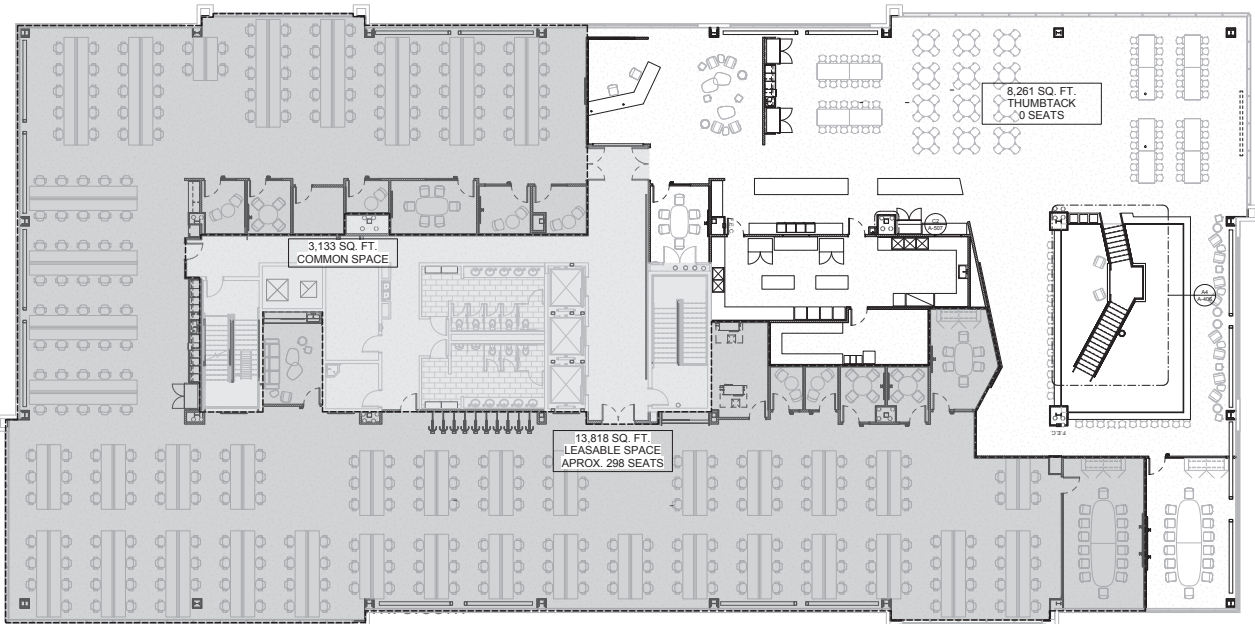

Independently Owned and Operated / A Member of the Cushman & Wakefield Alliance

Cushman & Wakefield Copyright 2015. No warranty or representation, express or implied, is made to the accuracy or completeness of the information contained herein, and same is submitted subject to errors, omissions, change of price, rental or other conditions, withdrawal without notice, and to any special listing conditions imposed by the property owner(s). As applicable, we make no representation as to the condition of the property (or properties) in question.
(path: G:\1 - Projects\Rossi, Jeff\1 - Flyer\VistaStation4\ VistaStation4)