

GIBSON PALMS CORPORATE PARK

100-118 CORPORATE PARK DR.
HENDERSON, NV 89074

7 BUILDINGS WITH 75,580 SF

1,220 - 1,474 SF



**CUSHMAN &
WAKEFIELD®**

COMMERCE

REAL ESTATE SOLUTIONS • COMRE.COM
INDEPENDENTLY OWNED AND OPERATED

FOR LEASE



PROPERTY FEATURES

- Great location off I-215 and Gibson
- 7 buildings with 75,580 SF
- Spaces available from 1,220 - 1,474 SF
- Flex space
- All spaces have grade door(s)
- Available immediately
- Call for details



For more information, please contact:

LEO BIEDERMANN
702.688.6943
lbiedermann@comre.com

CUSHMAN & WAKEFIELD | COMMERCE
3773 Howard Hughes Parkway, Suite 100 S
Las Vegas, Nevada 89169
(702) 796 7900
www.comre.com

©2013, Commerce Real Estate Solutions. Disclaimer: The above information is given with the obligation that all negotiations relating to the purchase, renting, or leasing of the property described above shall be conducted through Commerce Real Estate Solutions. No warranty or representation, express or implied, is made as to the accuracy of the information contained herein, and same is submitted subject to errors, omissions, change of price, rental or other encumbrances, withdrawal without notice, and to any special listing conditions imposed by the seller. Prospective buyers should conduct their own due diligence. Some aerial photography by DigitalGlobe or Aerials Express.
path: K:\1 - Projects\Las Vegas Office\Leo Biedermann\118 Corporate Park Drive

GIBSON PALMS CORPORATE PARK

100-118 Corporate Park Dr. | Henderson, NV 89074

FOR LEASE

118 Corporate Park Dr.

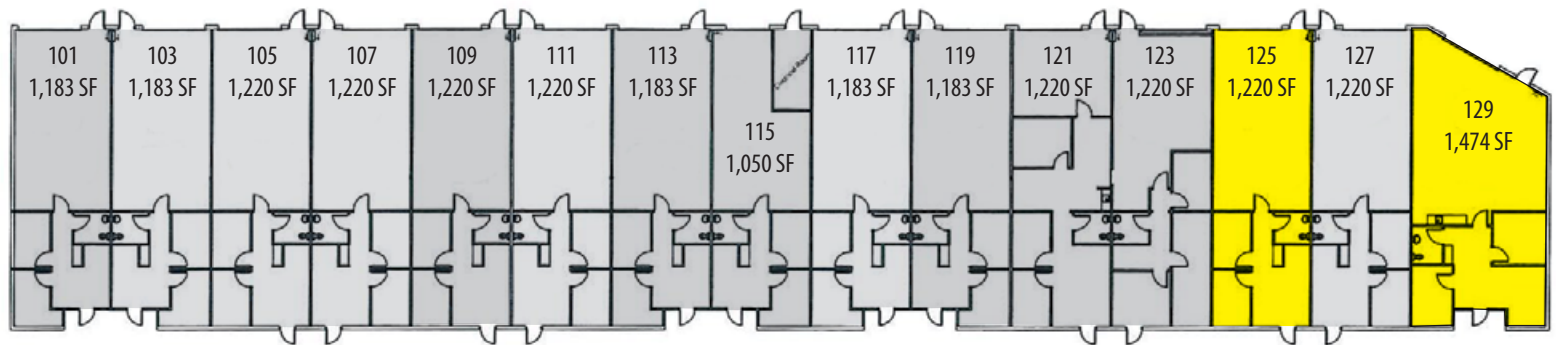

118 Corporate Park Dr.

■ AVAILABLE
■ LEASED

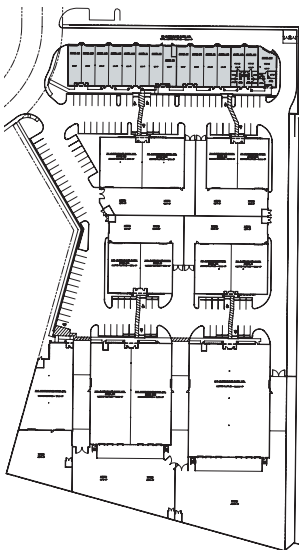

For more information, please contact:

LEO BIEDERMANN
702.688.6943
lbiedermann@comre.com

CUSHMAN & WAKEFIELD | COMMERCE
3773 Howard Hughes Parkway, Suite 100 S
Las Vegas, Nevada 89169
(702) 796 7900
www.comre.com

©2013, Commerce Real Estate Solutions. Disclaimer: The above information is given with the obligation that all negotiations relating to the purchase, renting, or leasing of the property described above shall be conducted through Commerce Real Estate Solutions. No warranty or representation, express or implied, is made as to the accuracy of the information contained herein, and same is submitted subject to errors, omissions, change of price, rental or other encumbrances, withdrawal without notice, and to any special listing conditions imposed by the seller. Prospective buyers should conduct their own due diligence. Some aerial photography by DigitalGlobe or Aerials Express.
path: K:\1 - Projects\Las Vegas Office\Leo Biedermann\118 Corporate Park Drive