

800 NORTH PARK CENTER SELAH, WASHINGTON 98942



**CUSHMAN &
WAKEFIELD®**

COMMERCE
REAL ESTATE SOLUTIONS • COMRE.COM
INDEPENDENTLY OWNED AND OPERATED

**FOR LEASE
44,000 SF EXISTING GROCERY STORE**

EXISTING GROCERY STORE



OFFERING FEATURES

LEASE RATE	Contact Agents
BUILDING SQ. FT.	44,000 SF Total ±
PARCEL SIZE	3.99 Acres ±
T.I. ALLOWANCE	Negotiable
PARKING	Ample - On-Site
ZONING	Local Business B-2
PARCEL NUMBER	18143621436
AVAILABLE	July 2016
LOCKBOX	No, Contact Agents for Tours

PROPERTY FEATURES

- Located in NorthPark Centre in Downtown Selah North of Yakima, WA
- High Traffic Location - 12,448 Average Daily Traffic
- Surrounded by Restaurants, Banking, Lodging, an Assisted Living Facility, Self Storage, Gas / Mini Mart, Carlon Park and Selah Junior High & High Schools
- 3 Mile Demographics - Population 16,746 | Avg. H.H. Income - \$61,117 | Businesses - 950
- Building Includes Large Windows, Multiple Entrances, Drive Down Docks, Large Parking Area & Pylon & Building Signage
- Do Not Disturb Existing Tenant
- Contact Agents to Schedule a Walk Through Today!!

For more information, please contact:

CAREN CHANDLER
Director
Retail Specialist
(206) 521-0283
caren.chandler@comre.com

CHUCK WINDER
Director
Office / Investment Specialist
(208) 287 9486
chuck.winder@comre.com

CUSHMAN & WAKEFIELD | COMMERCE
1420 Fifth Avenue, Suite 2600
Seattle, WA 98101
(206) 682-0666
www.comre.com

©2015, Commerce Real Estate Solutions. Disclaimer: The above information is given with the obligation that all negotiations relating to the purchase, renting, or leasing of the property described above shall be conducted through Commerce Real Estate Solutions. No warranty or representation, express or implied, is made as to the accuracy of the information contained herein, and same is submitted subject to errors, omissions, change of price, rental or other encumbrances, withdrawal without notice, and to any special listing conditions imposed by the seller. Prospective buyers should conduct their own due diligence. Some aerial photography by DigitalGlobe or Aerials Express.

800 NORTH PARK CENTER

SELAH, WASHINGTON 98942

FOR LEASE
GROCERY STORE
44,000 SF ON 3.99 ACRES

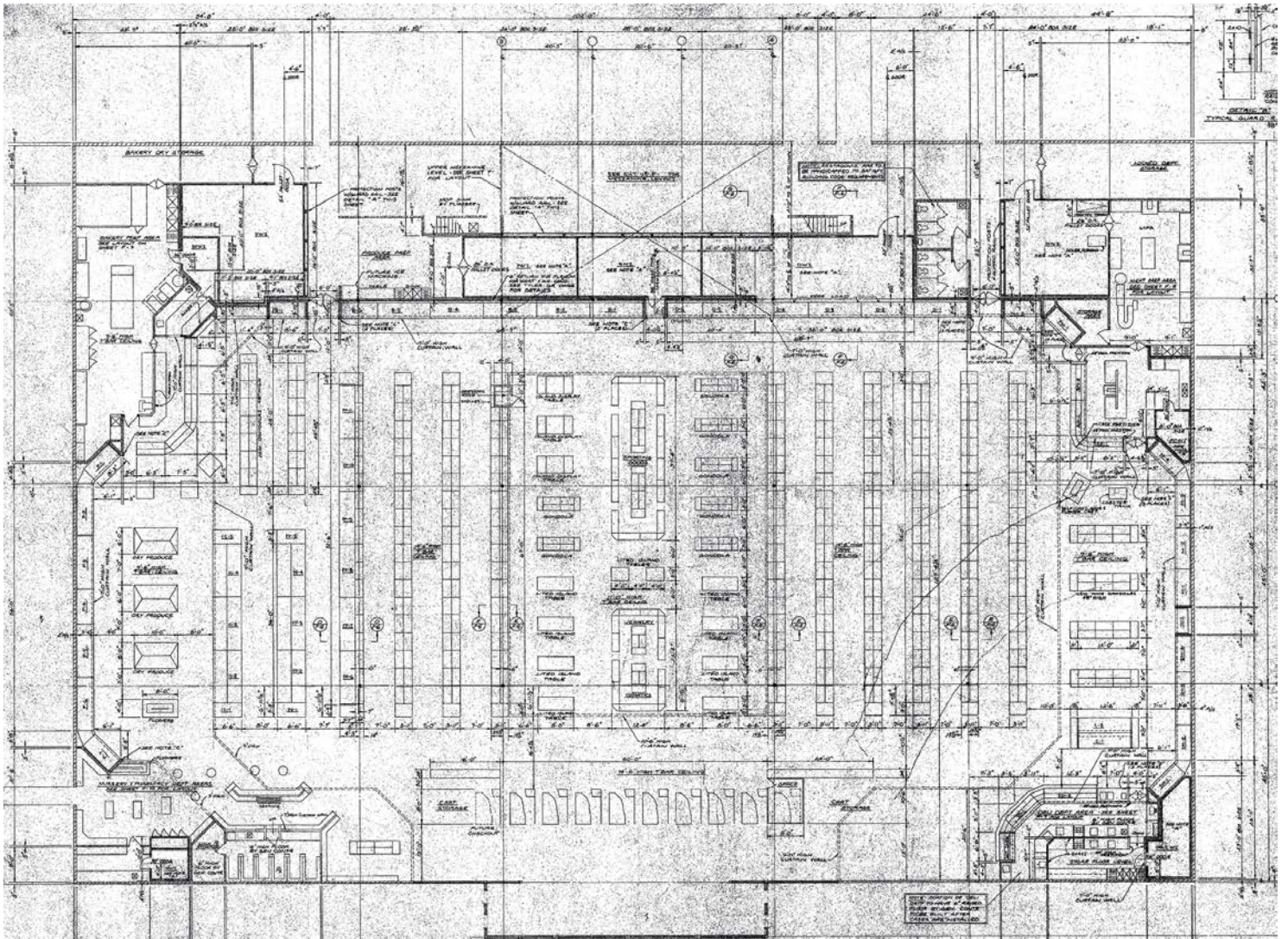

For more information, please contact:

CAREN CHANDLER

Director

Retail Specialist

(206) 521-0283

caren.chandler@comre.com

CHUCK WINDER

Director

Office / Investment Specialist

(208) 287 9486

chuck.winder@comre.com

CUSHMAN & WAKEFIELD | COMMERCE

1420 Fifth Avenue, Suite 2600

Seattle, WA 98101

(206) 682-0666

www.comre.com

©2014, Commerce Real Estate Solutions. Disclaimer: The above information is given with the obligation that all negotiations relating to the purchase, renting, or leasing of the property described above shall be conducted through Commerce Real Estate Solutions. No warranty or representation, express or implied, is made as to the accuracy of the information contained herein, and same is submitted subject to errors, omissions, change of price, rental or other encumbrances, withdrawal without notice, and to any special listing conditions imposed by the seller. Prospective buyers should conduct their own due diligence. Some aerial photography by DigitalGlobe or Aerials Express.

800 NORTH PARK CENTER

SELAH, WASHINGTON 98942

FOR LEASE
GROCERY STORE
44,000 SF ON 3.99 ACRES

DEMOGRAPHICS	1 MILE	3 MILE	5 MILE
POPULATION			
2014 Estimated Population	3,608	16,746	63,103
2019 Projected Population	3,632	17,181	64,740
HOUSEHOLDS			
2014 Estimated Households	1,318	6,128	22,725
2019 Projected Households	1,327	6,293	23,311
2014 Est. Average HH Income	\$49,683	\$51,015	\$39,423
2019 Est. Average HH Income	\$53,440	\$55,230	\$43,439
BUSINESSES / EMPLOYEES			
Total Businesses	229	950	4,308
Total Employees	1,786	5,522	27,704

SOURCE: U.S. BUREAU OF THE CENSUS, 2010 CENSUS OF POPULATION AND HOUSING.
ESRI FORECASTS FOR 2014 AND 2019. ESRI CONVERTED CENSUS 2000 DATA INTO 2010 GEOGRAPHY.

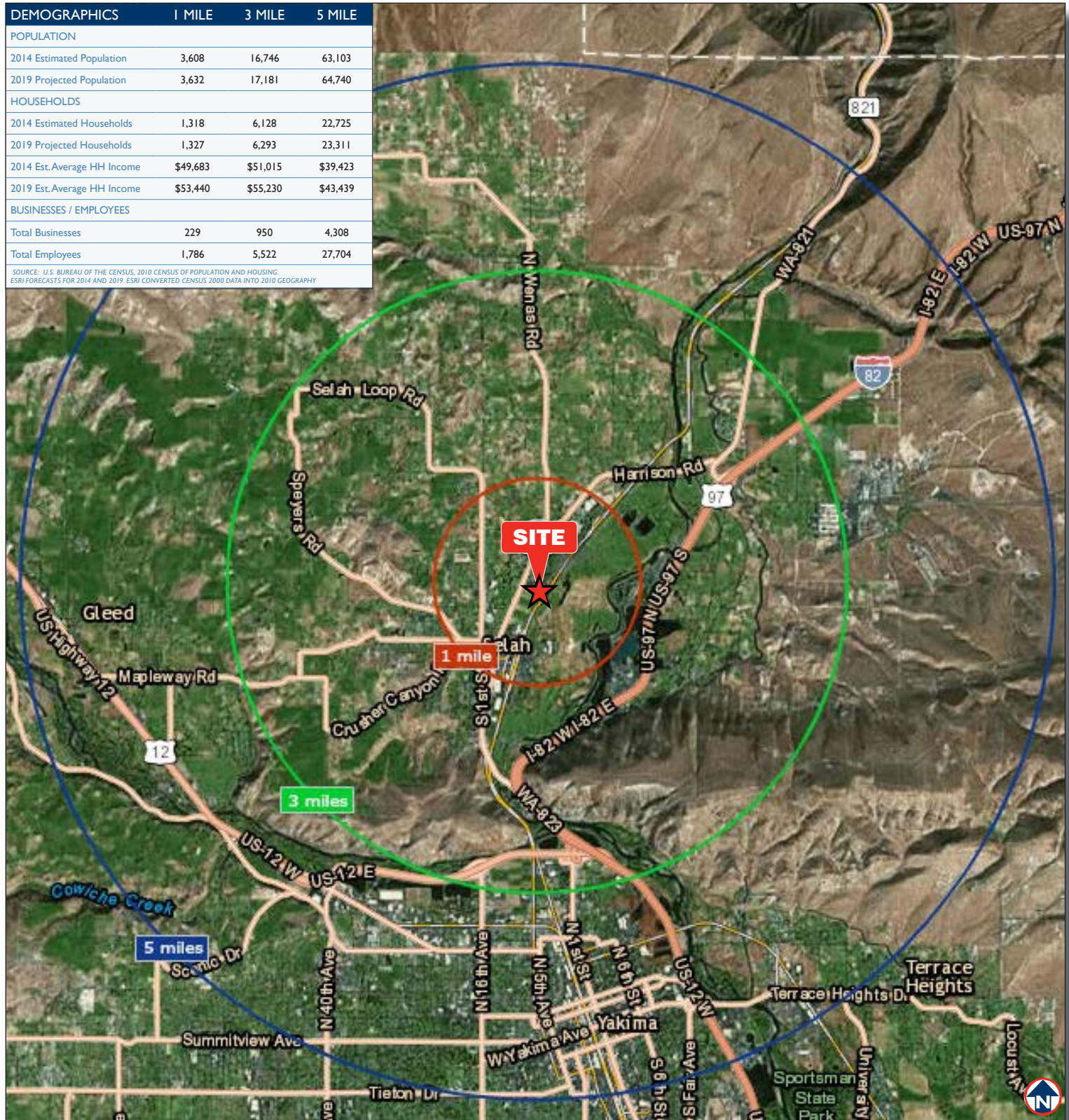

For more information, please contact:

CAREN CHANDLER
Director
Retail Specialist
(206) 521-0283
caren.chandler@comre.com

CHUCK WINDER
Director
Office / Investment Specialist
(208) 287 9486
chuck.winder@comre.com

CUSHMAN & WAKEFIELD | COMMERCE
1420 Fifth Avenue, Suite 2600
Seattle, WA 98101
(206) 682-0666
www.comre.com

©2014, Commerce Real Estate Solutions. Disclaimer: The above information is given with the obligation that all negotiations relating to the purchase, renting, or leasing of the property described above shall be conducted through Commerce Real Estate Solutions. No warranty or representation, express or implied, is made as to the accuracy of the information contained herein, and same is submitted subject to errors, omissions, change of price, rental or other encumbrances, withdrawal without notice, and to any special listing conditions imposed by the seller. Prospective buyers should conduct their own due diligence. Some aerial photography by DigitalGlobe or Aerials Express.