

HIGH-END OFFICE / WAREHOUSE

- ALL OFFERS WILL BE CONSIDERED
- LEASE OFFICE OR WAREHOUSE

FOR LEASE



Hughes Airport Center
955 Grier Drive, Suite A
Las Vegas, NV 89119

property information

- 1 block south of Sunset Rd. on SWC of Grier and Paradise in Hughes Airport Center
- Available for immediate occupancy
- Total of $\pm 16,388$ SF; $\pm 6,388$ SF office, $\pm 10,000$ SF warehouse
- High-end finishes
- 10 private offices
- 12 cubicles
- 2 sets of restrooms
- HVAC office; swamp-cooled warehouse
- Server room
- Landlord will lease office separately from warehouse
- Office and warehouse: \$0.79 PSF (NNN)
Office only: \$1.40 PSF (NNN)
Warehouse only: \$0.35 PSF (NNN)
- CAMs: \$0.17/SF/MO
- Lease terms: 3-5 years

marketed by:

Leo Biedermann **702.688.6943**
lbiedermann@comre.com

Geoffrey P. West **702.688.6936**
gwest@comre.com



CUSHMAN & WAKEFIELD

COMMERCE
REAL ESTATE SOLUTIONS • COMRE.COM

INDEPENDENTLY OWNED AND OPERATED

3773 Howard Hughes Pkwy., Suite 100 S • Las Vegas, Nevada 89169
Tel 702-796-7900 Fax 702-796-7920 • comre.com

HIGH-END OFFICE / WAREHOUSE



SUNSET RD

US Postal
Service

955 Grier

PARADISE RD

955 Grier Drive, Suite A
Las Vegas, NV 89119



CUSHMAN & WAKEFIELD

COMMERCE
REAL ESTATE SOLUTIONS • COMRE.COM
INDEPENDENTLY OWNED AND OPERATED

3773 Howard Hughes Pkwy., Suite 100 S • Las Vegas, Nevada 89169
Tel 702-796-7900 Fax 702-796-7920 • comre.com

marketed by:

Leo Biedermann **702.688.6943**
lbiedermann@comre.com

Geoffrey P. West **702.688.6936**
gwest@comre.com

©2013, Commerce Real Estate Solutions. Disclaimer: The above information is given with the obligation that all negotiations relating to the purchase, renting, or leasing of the property described above shall be conducted through Commerce Real Estate Solutions. No warranty or representation, express or implied, is made as to the accuracy of the information contained herein, and same is submitted subject to errors, omissions, change of price, rental or other encumbrances, withdrawal without notice, and to any special listing conditions imposed by the seller. Prospective buyers should conduct their own due diligence. Some aerial photography by DigitalGlobe or Aerials Express.
path: K:\T - Projects\Las Vegas Office\Leo Biedermann\955 Grier-Kirkorian

HIGH-END OFFICE / WAREHOUSE

OFFICE ONLY
±6,388 SF
\$1.40 PSF (NNN)

WAREHOUSE ONLY
±10,000 SF
\$0.35 PSF (NNN)

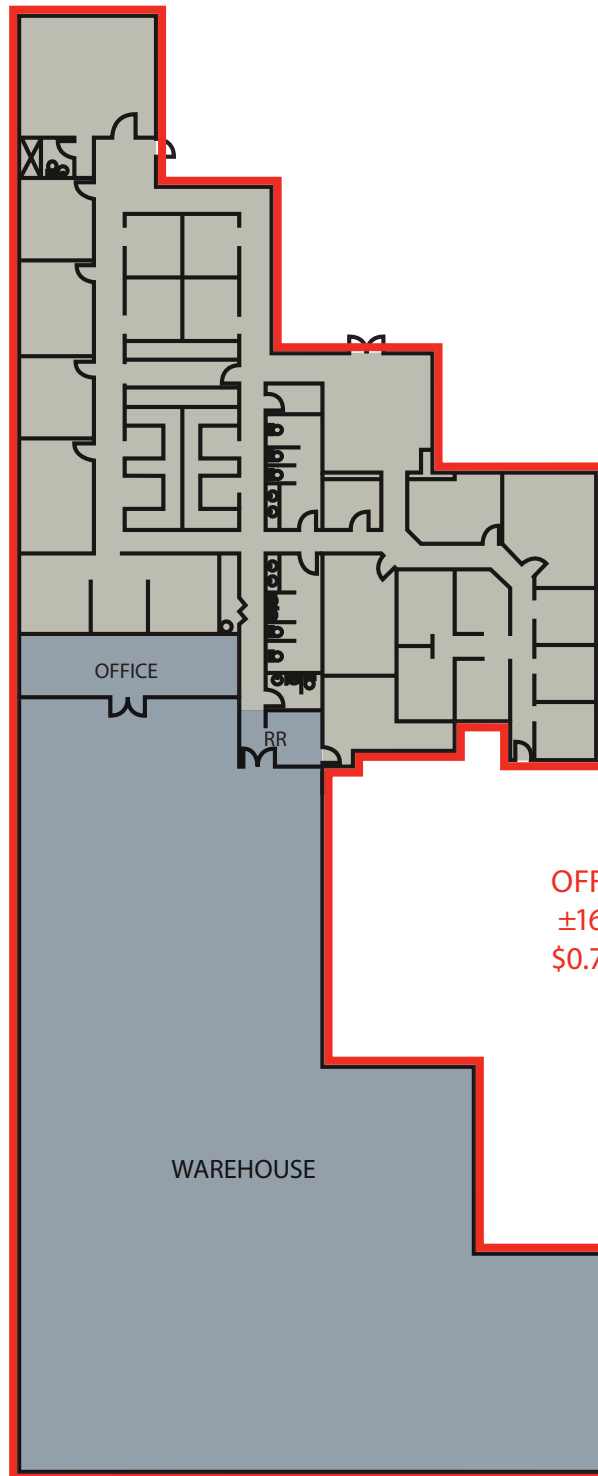

OFFICE & WAREHOUSE
±16,388 SF
\$0.79 PSF (NNN)

955 Grier Drive, Suite A
Las Vegas, NV 89119

marketed by:

Leo Biedermann 702.688.6943
lbiedermann@comre.com

Geoffrey P. West 702.688.6936
gwest@comre.com



CUSHMAN & WAKEFIELD

COMMERCE
REAL ESTATE SOLUTIONS • COMRE.COM

INDEPENDENTLY OWNED AND OPERATED

3773 Howard Hughes Pkwy., Suite 100 S • Las Vegas, Nevada 89169
Tel 702-796-7900 Fax 702-796-7920 • comre.com

©2013, Commerce Real Estate Solutions. Disclaimer: The above information is given with the obligation that all negotiations relating to the purchase, renting, or leasing of the property described above shall be conducted through Commerce Real Estate Solutions. No warranty or representation, express or implied, is made as to the accuracy of the information contained herein, and same is submitted subject to errors, omissions, change of price, rental or other encumbrances, withdrawal without notice, and to any special listing conditions imposed by the seller. Prospective buyers should conduct their own due diligence. Some aerial photography by DigitalGlobe or Aerials Express.
path: K:\T - Projects\Las Vegas Office\Leo Biedermann\955 Grier-Kirkorian

HIGH-END OFFICE / WAREHOUSE

Office

- High-end finishes
- Travertine floor
- Italian made doors and windows
- Built-ins in offices
- 10 private offices
- Executive office with private restroom
- 12 cubicles
- Granite counter tops throughout
- Server room
- CAT-5 wired throughout
- File room
- 2 sets of restrooms plus warehouse restroom
- File/mail/copy room
- Sprinkler system throughout
- HVAC
- Kitchen area



955 Grier Drive, Suite A
Las Vegas, NV 89119

marketed by:

Leo Biedermann 702.688.6943
lbiedermann@comre.com

Geoffrey P. West 702.688.6936
gwest@comre.com



CUSHMAN & WAKEFIELD

COMMERCE
REAL ESTATE SOLUTIONS • COMRE.COM

INDEPENDENTLY OWNED AND OPERATED

3773 Howard Hughes Pkwy., Suite 100 S • Las Vegas, Nevada 89169
Tel 702-796-7900 Fax 702-796-7920 • comre.com

©2013, Commerce Real Estate Solutions. **Disclaimer:** The above information is given with the obligation that all negotiations relating to the purchase, renting, or leasing of the property described above shall be conducted through Commerce Real Estate Solutions. No warranty or representation, express or implied, is made as to the accuracy of the information contained herein, and same is submitted subject to errors, omissions, change of price, rental or other encumbrances, withdrawal without notice, and to any special listing conditions imposed by the seller. Prospective buyers should conduct their own due diligence. Some aerial photography by DigitalGlobe or Aerials Express.
path: K:\T - Projects\Las Vegas Office\Leo Biedermann\955 Grier-Kirkorian

HIGH-END OFFICE / WAREHOUSE

Warehouse

- Two 12'x14' electric roll-up doors
- Two man doors
- Office
- Restroom
- Swamp cooled
- Freeze protection
- 22' clear height
- 120/208 power
- Shared dock-high loading
- Locakable store room
- 120/208v, 3-phase power
- 100% sprinklered throughout
- Natural gas
- Broadband



955 Grier Drive, Suite A
Las Vegas, NV 89119

marketed by:

Leo Biedermann **702.688.6943**
lbiedermann@comre.com

Geoffrey P. West **702.688.6936**
gwest@comre.com



CUSHMAN & WAKEFIELD

COMMERCE
REAL ESTATE SOLUTIONS • COMRE.COM

INDEPENDENTLY OWNED AND OPERATED

3773 Howard Hughes Pkwy., Suite 100 S • Las Vegas, Nevada 89169
Tel 702-796-7900 Fax 702-796-7920 • comre.com

©2013, Commerce Real Estate Solutions. Disclaimer: The above information is given with the obligation that all negotiations relating to the purchase, renting, or leasing of the property described above shall be conducted through Commerce Real Estate Solutions. No warranty or representation, express or implied, is made as to the accuracy of the information contained herein, and same is submitted subject to errors, omissions, change of price, rental or other encumbrances, withdrawal without notice, and to any special listing conditions imposed by the seller. Prospective buyers should conduct their own due diligence. Some aerial photography by DigitalGlobe or Aerials Express. path: K:\T - Projects\Las Vegas Office\Leo Biedermann\955 Grier-Kirkorian